

# Exam Questions MS-900

Microsoft 365 Fundamentals

<https://www.2passeasy.com/dumps/MS-900/>



### NEW QUESTION 1

A company has a Microsoft 365 subscription that includes Office apps.

A user has identified a new issue while working with an app. When the user attempts to create a support request, the following message displays:

You don't have permission to access this page or perform this action.

You need to determine the cause of the error message. What is the cause?

- A. The user account is disabled.
- B. The user does not have a license assigned for the app.
- C. The user account is not a member of the global admin role.
- D. The company does not have Premier support.

Answer: C

### NEW QUESTION 2

You are a Microsoft 365 administrator for a company.

You need to recommend an-appropriate Microsoft Office 365 plan for a customer that minimizes costs. Which subscription plans should you recommend? To answer, drag the appropriate plans to the correct features. Each plan may be used once, more than once, or not at all.

NOTE: Each correct selection is worth one point.

Office 365 plans	Office 365 feature	Office 365 plan
ProPlus	Local copy of Microsoft Outlook that connects to an Exchange Server instance.	Office 365 plan
Enterprise E1	Search and discovery with Delve.	Office 365 plan
Enterprise E3	eDiscovery with in-place, hold, and export	Office 365 plan
Enterprise E5	Advanced eDiscovery with in-place search, hold, export, and analytics.	Office 365 plan

- A. Mastered
- B. Not Mastered

Answer: A

#### Explanation:

References:

<https://products.office.com/en-us/business/compare-more-office-365-for-business-plans>

### NEW QUESTION 3

A company uses Microsoft 36S. The company has an application that runs on a device that does not have internet access. The device can only be updated manually every two years. You need to determine how you should update the device. Select the answer that correctly completes the sentence.

Answer Area

Deploy and update Windows as a service (WaaS) to this device by using

General Availability Channel

Long-Term Servicing Channel

Windows Insider Program

Microsoft Intune

- A. Mastered
- B. Not Mastered

Answer: A

#### Explanation:

Answer Area

Deploy and update Windows as a service (WaaS) to this device by using

General Availability Channel

Long-Term Servicing Channel

Windows Insider Program

Microsoft Intune

#### NEW QUESTION 4

For each of the following statements, select Yes if the statement is true. Otherwise, select No. NOTE: Each correct selection is worth one point.

Statement	Yes	No
Infrastructure as a Service (IaaS) provides servers, virtual machines (VMs), storage, networks, and operating systems to customers.	<input type="radio"/>	<input type="radio"/>
Platform as a Service (PaaS) provides an environment for building, testing, and deploying software applications.	<input type="radio"/>	<input type="radio"/>
Software as a Service (SaaS) provides an environment that is centrally hosted and managed for customers.	<input type="radio"/>	<input type="radio"/>

- A. Mastered  
 B. Not Mastered

Answer: A

Explanation:

Statement	Yes	No
Infrastructure as a Service (IaaS) provides servers, virtual machines (VMs), storage, networks, and operating systems to customers.	<input checked="" type="radio"/>	<input type="radio"/>
Platform as a Service (PaaS) provides an environment for building, testing, and deploying software applications.	<input checked="" type="radio"/>	<input type="radio"/>
Software as a Service (SaaS) provides an environment that is centrally hosted and managed for customers.	<input checked="" type="radio"/>	<input type="radio"/>

#### NEW QUESTION 5

For each of the following statements, select Yes if the statement is true. Otherwise, select No. NOTE: Each correct selection is worth one point.

Answer Area		
Statement	Yes	No
Microsoft cloud services offer significant energy savings for Microsoft and its customers.	<input type="radio"/>	<input type="radio"/>
Lower costs, no hardware maintenance, near-unlimited scalability, and high reliability are all advantages of a private cloud.	<input type="radio"/>	<input type="radio"/>
Microsoft cloud services offer security options and have the ability to provision resources quickly.	<input type="radio"/>	<input type="radio"/>

- A. Mastered  
 B. Not Mastered

Answer: A

Explanation:

References:

<https://blogs.microsoft.com/on-the-issues/2018/05/17/microsoft-cloud-delivers-when-it-comes-to-energy-efficie> <https://www.liquidweb.com/blog/private-cloud/>  
<https://docs.microsoft.com/en-us/azure/architecture/cloud-adoption/getting-started/azure-resource-access> <https://azure.microsoft.com/en-gb/product-categories/security/>

#### NEW QUESTION 6

For each of the following statements, select Yes if the statement is true. Otherwise, select No. NOTE: Each correct selection is worth one point.



Statement	Yes	No
By default, all Microsoft 365 subscribers are configured for targeted release.	<input type="radio"/>	<input type="radio"/>
To enable or disable targeted releases in an organization, select each user who should receive early access to features and functionality from a list.	<input type="radio"/>	<input type="radio"/>
To enable Microsoft Office Insider release in an organization, select each user who should receive preview access to features and functionality from a list.	<input type="radio"/>	<input type="radio"/>

- A. Mastered  
 B. Not Mastered

Answer: A

**Explanation:**

References:

<https://docs.microsoft.com/en-us/deployoffice/change-management-for-office-365-clients> <https://docs.microsoft.com/en-us/office365/admin/manage/release-options-in-office-365?view=o365-worldwide>

**NEW QUESTION 7**

An organization is considering migrating resources to the cloud. The company does not plan to deploy Microsoft Azure ExpressRoute or site-to-site VPNs. You need to identify which workloads you can migrate to the cloud.

Which workloads you can migrate to the cloud? To answer, drag the appropriate actions to the correct workloads. Each action may be used once, more than once, or not at all. You may need to drag the split bar between panes or scroll to view content.

NOTE: Each correct selection is worth one point.

Actions	Workload	Action
Migrate to the cloud	You have a legacy application that requires connectivity with an on-premises data store.	Action
Remain on-premises	You need to deploy an external-facing website.	Action
	You need to deploy a Microsoft SharePoint collaboration site for partners.	Action

- A. Mastered  
 B. Not Mastered

Answer: A

**Explanation:**

Actions	Workload	Action
Migrate to the cloud	You have a legacy application that requires connectivity with an on-premises data store.	Remain on-premises
Remain on-premises	You need to deploy an external-facing website.	Migrate to the cloud
	You need to deploy a Microsoft SharePoint collaboration site for partners.	Migrate to the cloud

**NEW QUESTION 8**

Instructions: For each of the following statements, select Yes if the statement is true. Otherwise, select No. NOTE: Each correct selection is worth one point.

Answer Area

Statements	Yes	No
Cloud App Security identifies the cloud apps, infrastructure as a service (IaaS), and platform as a service (PaaS) services an organization uses.	<input type="radio"/>	<input type="radio"/>
Cloud App Security detects unusual behavior across apps and users as well as potential ransomware.	<input type="radio"/>	<input type="radio"/>
Cloud App Security prevents data leaks from noncompliant apps and limits access to regulated data.	<input type="radio"/>	<input type="radio"/>

- A. Mastered  
 B. Not Mastered

Answer: A

**Explanation:**

#### Answer Area

Statements	Yes	No
Cloud App Security identifies the cloud apps, infrastructure as a service (IaaS), and platform as a service (PaaS) services an organization uses.	<input checked="" type="radio"/>	<input type="radio"/>
Cloud App Security detects unusual behavior across apps and users as well as potential ransomware.	<input checked="" type="radio"/>	<input type="radio"/>
Cloud App Security prevents data leaks from noncompliant apps and limits access to regulated data.	<input checked="" type="radio"/>	<input type="radio"/>

#### NEW QUESTION 9

For each of the following statements, select Yes if the statement is true. Otherwise, select No. NOTE: Each correct selection is worth one point.

Statement	Yes	No
Microsoft Bookings can modify or cancel an existing booking.	<input type="radio"/>	<input type="radio"/>
Microsoft Bookings can only use a corporate website to create a booking.	<input type="radio"/>	<input type="radio"/>
Microsoft Bookings can create a booking based on a user's schedule.	<input type="radio"/>	<input type="radio"/>

- A. Mastered  
B. Not Mastered

Answer: A

Explanation:

Statement	Yes	No
Microsoft Bookings can modify or cancel an existing booking.	<input checked="" type="radio"/>	<input type="radio"/>
Microsoft Bookings can only use a corporate website to create a booking.	<input type="radio"/>	<input checked="" type="radio"/>
Microsoft Bookings can create a booking based on a user's schedule.	<input checked="" type="radio"/>	<input type="radio"/>

#### NEW QUESTION 10

You are the Microsoft 365 administrator for a company.

An employee requests personal data under General Data Protection Regulation (GDPR) guidelines. You need to retrieve data for the employee. What should you do?

- A. Create a data subject request case.  
B. Create a retention policy.  
C. Create a data-loss prevention policy.  
D. Create a GDPR assessment

Answer: A

Explanation:

References:

<https://docs.microsoft.com/en-us/microsoft-365/compliance/gdpr-dsr-office365>

#### NEW QUESTION 10

For each of the following statements, select Yes if the statement is true. Otherwise, select No. NOTE: Each correct selection is worth one point.

Statement	Yes	No
It is possible to connect cloud services to on-premises server resources.	<input type="radio"/>	<input type="radio"/>
Scaling cloud-hosted infrastructure components includes expanding server resources and networking components.	<input type="radio"/>	<input type="radio"/>

- A. Mastered  
B. Not Mastered

**Answer:** A

**Explanation:**

Statement	Yes	No
It is possible to connect cloud services to on-premises server resources.	<input checked="" type="radio"/>	<input type="radio"/>
Scaling cloud-hosted infrastructure components includes expanding server resources and networking components.	<input checked="" type="radio"/>	<input type="radio"/>

#### NEW QUESTION 11

A company is evaluating Microsoft 365.

You need to identify the benefits of an Enterprise Agreement. What is a benefit of an Enterprise Agreement?

- A. All licenses are perpetual
- B. Simplified per-device licensing model.
- C. Simplified non-expiring licensing model
- D. Locked-in pricing for the duration of the term.

**Answer:** C

#### NEW QUESTION 13

A company plans to migrate to Microsoft 365.

You need to advise the company about how Microsoft provides protection in a multitenancy environment. What are three ways that Microsoft provides protection?

Each correct answer presents part of the solution.

NOTE: Each correct selection is worth one point.

- A. Customer content at rest is encrypted on the server by using BitLocker.
- B. Microsoft Azure AD provides authorization and role based access control at the tenant layer.
- C. Customer content at rest is encrypted on the server by using transport layer security (TLS).
- D. Microsoft Azure AD provides authorization and role based access control at the transport layer.
- E. Mailbox databases in Microsoft Exchange Online contain only mailboxes from a single tenant.
- F. Mailbox databases in Microsoft Exchange Online contain mailboxes from multiple tenants.

**Answer:** ABF

**Explanation:**

A: <https://docs.microsoft.com/en-us/microsoft-365/compliance/office-365-encryption-in-the-microsoft-cloud-o> B: <https://docs.microsoft.com/en-us/microsoft-365/enterprise/microsoft-365-tenant-isolation-overview?view=o> F: <https://docs.microsoft.com/en-us/microsoft-365/enterprise/microsoft-365-isolation-in-microsoft-365?view=o>

#### NEW QUESTION 16

A company uses Microsoft 365.

The company wants to automate an approval process for invoices by using Microsoft Teams. You need to identify the solution to create the workflow.

Which three solutions can achieve the goal? Each correct answer presents a complete solution.

NOTE: Each correct selection is worth one point.

- A. Power Automate
- B. Power Virtual Agents
- C. Power BI
- D. Microsoft Forms
- E. Power Apps

**Answer:** ABE

#### NEW QUESTION 18

You are the Microsoft 365 administrator for a company.

Users in the IT department must receive new Office 365 preview features before the features are deployed to other users in the company.

You need to ensure only the users in the IT department receive preview features.

Which two actions should you perform? Each correct answer represents part of the solution. (Choose two.) NOTE: Each correct selection is worth one point.

- A. Instruct users to navigate to <http://insider.office.com> and sign up for Office Insider.
- B. Instruct users to update Office ProPlus.
- C. In the organizational profile, set the update preference to Targeted release for selected users.
- D. Instruct users to uninstall Office ProPlus and then reinstall the software.
- E. In the organizational profile, set the update preference to Standard release.

**Answer:** AC

**Explanation:**

References:



<https://insider.office.com/en-us/>  
<https://docs.microsoft.com/en-us/office365/admin/manage/release-options-in-office-365?view=o365-worldwide>

### NEW QUESTION 21

A company plans to deploy a compliance solution in Microsoft 365.

Match each compliance solution to its description. To answer, drag the appropriate compliance solution from the column on the left to its description on the right.

Each compliance solution may be used once, more than once, or not at all.

NOTE: Each correct match is worth one point.

Compliance solutions	Answer Area	
	Compliance description	Compliance solution
Records management	Provides policies to automatically apply retention labels to documents in an organization	
Insider risk management	Provides policies to discover and act on malicious and inadvertent risk activities in an organization	
Advanced eDiscovery	Provides a workflow to preserve, collect, and manage content for an organization's internal and external investigations	

- A. Mastered
- B. Not Mastered

Answer: A

### Explanation:

Compliance solutions	Answer Area	
	Compliance description	Compliance solution
Records management	Provides policies to automatically apply retention labels to documents in an organization	Records management
Insider risk management	Provides policies to discover and act on malicious and inadvertent risk activities in an organization	Insider risk management
Advanced eDiscovery	Provides a workflow to preserve, collect, and manage content for an organization's internal and external investigations	Advanced eDiscovery

### NEW QUESTION 22

A company uses Microsoft 365.

The company wants to create a workflow that integrates with Microsoft Teams. What should you use to create the workflow?

- A. Dynamics 365 Customer Service
- B. Power BI
- C. Power Automate
- D. SharePoint Online
- E. Dynamics 365 Commerce

Answer: C

### NEW QUESTION 26

A company uses Microsoft 365.

A manager wants to increase the efficiency of team members.

You need to identify the tools that can help improve team effectiveness.

Which tool should you identify for each requirement? To answer, drag the appropriate tools to the correct requirements. Each tool may be used once, more than once, or not at all. You may need to drag the split bar between panes or scroll to view content.

NOTE: Each correct selection is worth one point.

Tools	Answer Area	
	Requirement	Tool
MyAnalytics	Analyze collective insight into the effectiveness of meetings that team members attend.	
Workplace Analytics	Automatically recommend actions to individuals within Microsoft Outlook that can potentially increase productivity.	
Microsoft Teams		
Power Platform		

- A. Mastered
- B. Not Mastered

Answer: A

Explanation:

Tools	Requirement	Tool
MyAnalytics	Analyze collective insight into the effectiveness of meetings that team members attend.	Workplace Analytics
Workplace Analytics		
Microsoft Teams	Automatically recommend actions to individuals within Microsoft Outlook that can potentially increase productivity.	MyAnalytics
Power Platform		

NEW QUESTION 29

You are evaluating Office 365 ProPlus for a company.  
For each of the following statements, select Yes if the statement is true. Otherwise, select No. NOTE: Each correct selection is worth one point.

Statements	Yes	No
Employees must use a browser to co-author documents, spreadsheets, and presentations.	<input type="radio"/>	<input type="radio"/>
Employees can edit documents, spreadsheets, and presentations by using a browser or the desktop app.	<input type="radio"/>	<input type="radio"/>
Employees can use mobile devices, tablets, and laptops to edit documents, spreadsheets, and presentations.	<input type="radio"/>	<input type="radio"/>

- A. Mastered
- B. Not Mastered

Answer: A

Explanation:

Statements	Yes	No
Employees must use a browser to co-author documents, spreadsheets, and presentations.	<input type="radio"/>	<input checked="" type="radio"/>
Employees can edit documents, spreadsheets, and presentations by using a browser or the desktop app.	<input checked="" type="radio"/>	<input type="radio"/>
Employees can use mobile devices, tablets, and laptops to edit documents, spreadsheets, and presentations.	<input checked="" type="radio"/>	<input type="radio"/>

NEW QUESTION 31

A company is evaluating solutions to improve their customer service capabilities.  
When customers call the company, they should be directly routed to the appropriate customer service person You need to recommend solutions for the company's requirements.  
Which solutions should you recommend? TO answer, select the appropriate options in the answer area.



Requirement	Solution
Implement Direct Routing.	<div>Microsoft Teams Phone</div> <div>Outlook People</div> <div>Yammer</div> <div>Microsoft Viva</div>
Connect the correct customer service associate to a customer.	<div>Microsoft Viva</div> <div>Outlook People</div> <div>Microsoft Teams Phone</div> <div>Microsoft Stream</div>

- A. Mastered  
B. Not Mastered

Answer: A

Explanation:

Requirement	Solution
Implement Direct Routing.	<div>Microsoft Teams Phone</div> <div>Outlook People</div> <div>Yammer</div> <div>Microsoft Viva</div>
Connect the correct customer service associate to a customer.	<div>Microsoft Viva</div> <div>Outlook People</div> <div>Microsoft Teams Phone</div> <div>Microsoft Stream</div>

NEW QUESTION 36

A company is evaluating Microsoft cloud service offerings. Match each offering to the cloud service.  
Instructions: To answer, drag the appropriate offering from the column on the left to the cloud service on the right. Each offering might be used once, more than once, or not at all.  
NOTE: Each correct selection is worth one point.

Offerings	Answer Area	
	Cloud service	Offering
<div>Booking calendar</div>	Infrastructure as a service (IaaS)	
<div>Booking page</div>	Platform as a service (PaaS)	
<div>Staff page</div>	Software as a service (SaaS)	
<div>Services page</div>		

- A. Mastered  
B. Not Mastered

Answer: A

Explanation:

Graphical user interface, application Description automatically generated

NEW QUESTION 41

A company has a Microsoft 365 subscription and a Microsoft Azure support plan.  
You need to implement only Azure services for which Microsoft provides technical support.  
Which two types of services and features can you implement? Each correct answer presents part of the solution.  
NOTE: Each correct selection is worth one point.

- A. general availability

- B. targeted release
- C. public preview
- D. private preview

Answer: AC

Explanation:

https://docs.microsoft.com/en-us/microsoft-365/admin/manage/release-options-in-office-365?view=o365-world

NEW QUESTION 43

A company is evaluating Microsoft's virtualization services. Which feature is unique to Windows 365?

- A. A virtual machine can be provisioned from a custom image.
- B. A virtual machine is automatically provisioned after assigning a license to a user
- C. Users can connect to a virtual machine by using the Microsoft Remote Desktop app
- D. Users can connect to a virtual machine by using a web site.
- E. A virtual machine can authenticate users to Active Directory Domain Services (AD DS).

Answer: B

NEW QUESTION 47

A company plans to adopt Microsoft cloud solutions.

You need to identity which platform is appropriate for each solution component.

Which platform should you select? To answer, drag the appropriate platforms to the correct solution components. Each platform may be used once, more than once, or not at all. You may need to drag the split bar between panes or scroll to view content.

NOTE: Each correct selection is worth one point.

Platforms

Dynamics 365

Microsoft Azure

Answer Area

Solution component

Microsoft-developed customer relationship management (CRM) application

Windows virtual machine

Microsoft-developed enterprise resource planning (ERP) application

Platform

Platform

Platform

Platform

- A. Mastered
- B. Not Mastered

Answer: A

Explanation:

Platforms

Dynamics 365

Microsoft Azure

Answer Area

Solution component

Microsoft-developed customer relationship management (CRM) application

Windows virtual machine

Microsoft-developed enterprise resource planning (ERP) application

Platform

Dynamics 365

Microsoft Azure

Dynamics 365

NEW QUESTION 49

A company plans to use the reports that are available in Microsoft 365 usage analytics.

Match each report to its description. To answer, drag the appropriate report from the column on the left to its description the right. Each term may be used once, more than once, or not at all.

NOTE: Each correct selection is worth one point.

Reports

Communication

Collaboration

Mobility

Storage

Usage

Answer Area

Description

Provides the number of active users and the primary activities of each product for the last 12 months

Identifies patterns in the use of Microsoft Teams and Yammer among users

Identifies the number of documents that are shared internally or externally

Report

- A. Mastered
- B. Not Mastered

**Answer:** A

**Explanation:**

Graphical user interface, application Description automatically generated

Usage – Offers a drill-down view into the volume of active users and the key activities for each product for the last 12 months. Use the reports in this section to learn how people in your organization are using Microsoft 365.

Communication – You can see at a glance whether people in your organization prefer to stay in touch by using Teams, Yammer, email, or Skype calls. You can observe if there are shifts in patterns in the use of communication tools among your employees.

Collaboration – See how people in your organization use OneDrive and SharePoint to store documents and collaborate with each other, and how these trends evolve month over month. You can also see how many users shared documents internally or externally and how many users used SharePoint sites or OneDrive accounts, broken out by owners and other collaborators.

Storage – Use this report to track cloud storage for mailboxes, OneDrive, and SharePoint sites. Mobility – Track which clients and devices people use to connect to email, Teams, Skype, or Yammer.

**NEW QUESTION 51**

For each of the following statements, select Yes if the statement is true. Otherwise, select No. NOTE: Each correct selection is worth one point.

Statement	Yes	No
Microsoft 365 global administrators use Microsoft Workplace Analytics to examine network traffic patterns for troubleshooting purposes.	<input type="radio"/>	<input type="radio"/>
Microsoft Workplace Analytics can be helpful in understanding the collaboration patterns and usage of various Microsoft 365 services.	<input type="radio"/>	<input type="radio"/>
Microsoft Worplace Analytics helps employees work more efficiently so that thay can become more productive.	<input type="radio"/>	<input type="radio"/>

- A. Mastered
- B. Not Mastered

**Answer:** A

**Explanation:**

References:

<https://docs.microsoft.com/en-us/workplace-analytics/index-orig> <https://docs.microsoft.com/en-us/workplace-analytics/overview/get-started>

**NEW QUESTION 52**

A company is evaluating Microsoft 365.

The company needs an add-on licensing solution that will protect against privacy risks.

You need to determine a solution. Which solution should you use?

- A. Safe Attachments
- B. Microsoft Purview
- C. Microsoft Priva
- D. Azure Monitor

**Answer:** C

**NEW QUESTION 57**

A company uses Microsoft 365 Business to address its compliance needs. A customer requests a complete disclosure of all personal data that relates to them.

You need to create a new data subject request (DSR) case and ensure that compliance managers can view all DSR case findings.

In which two areas must you perform actions? To answer, select the appropriate options in the answer area. NOTE: Each correct selection is worth one point.



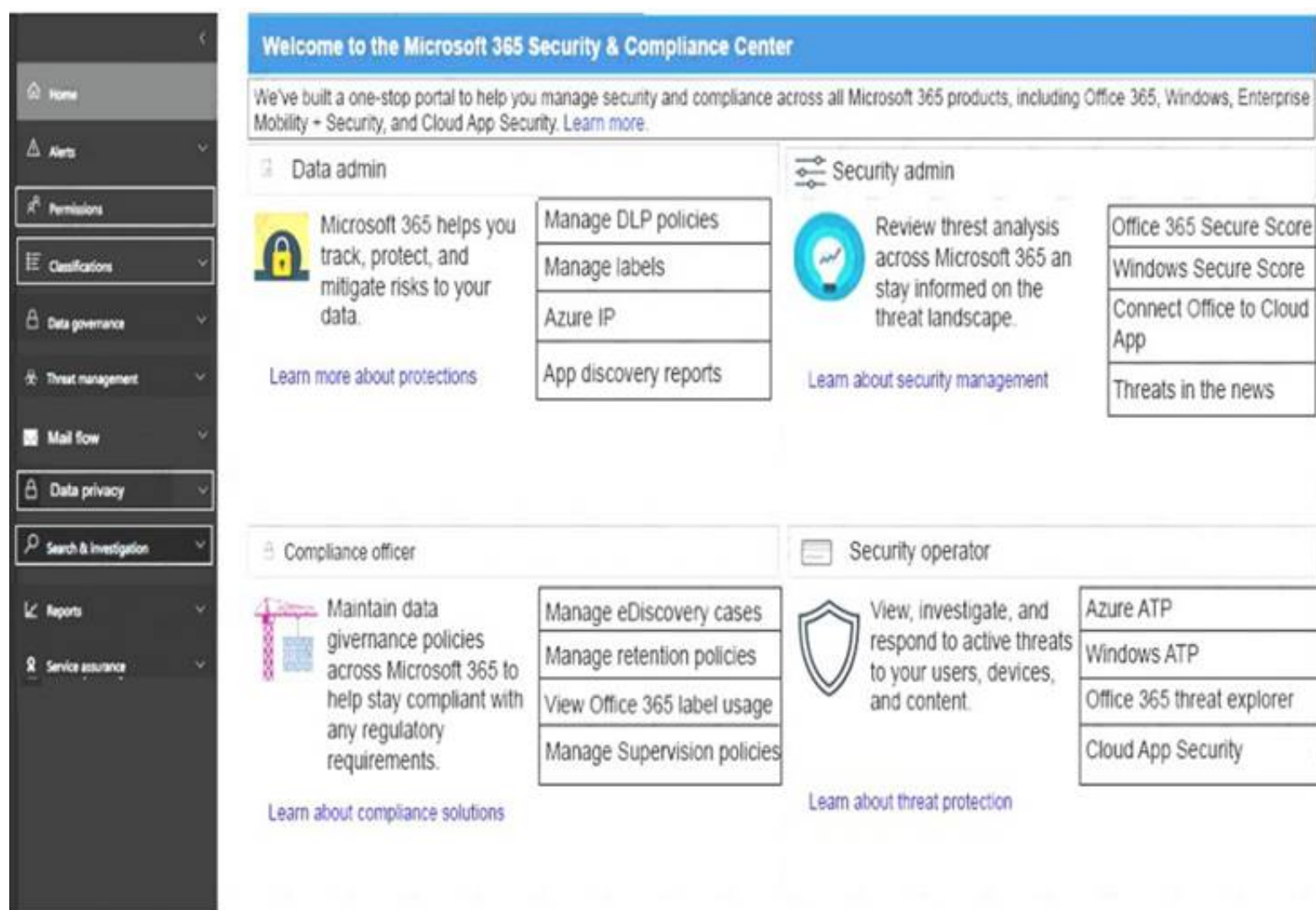

- A. Mastered  
 B. Not Mastered

Answer: A

Explanation:

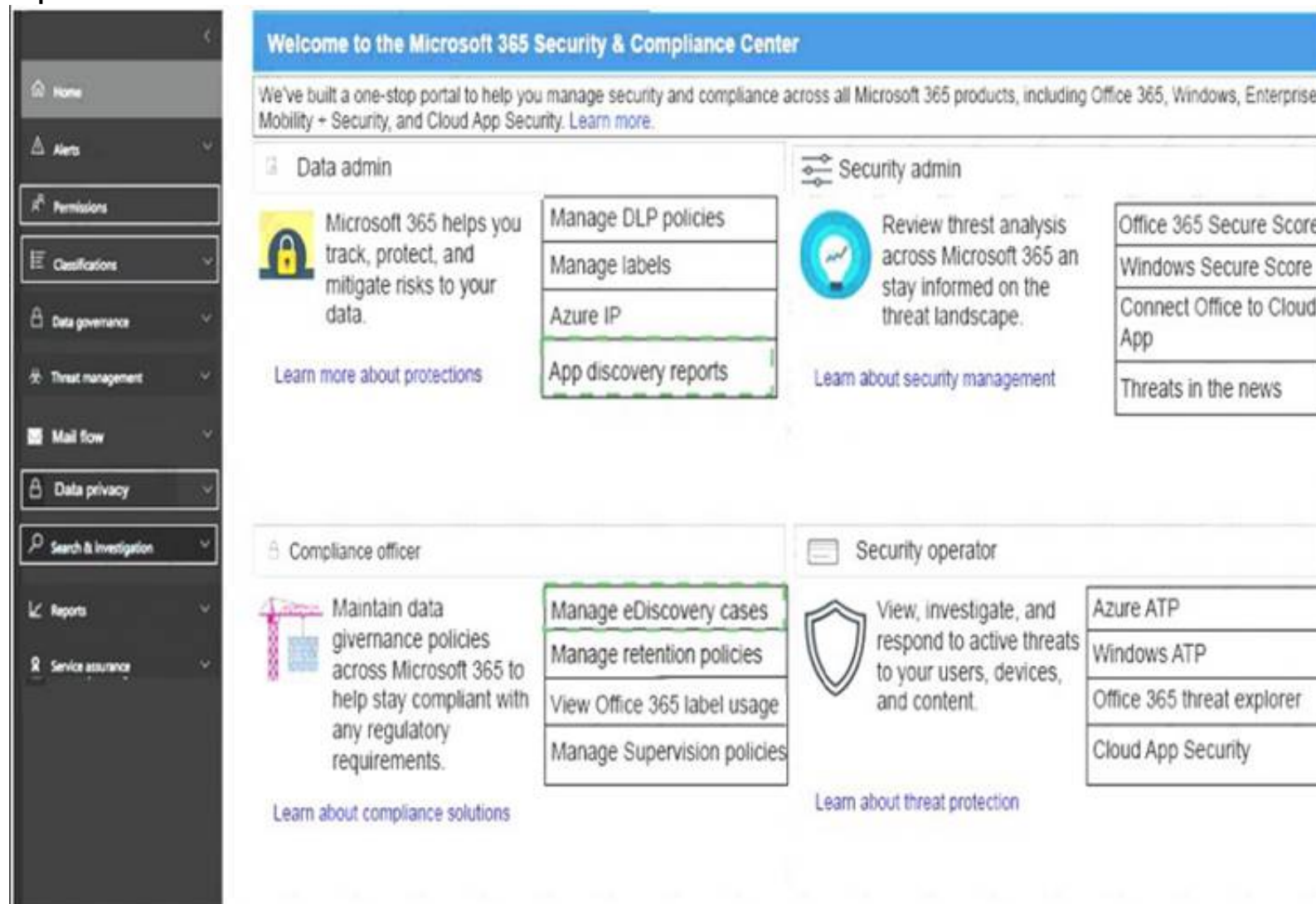

#### NEW QUESTION 60

You are implementing Azure cloud services.

Match each scenario to its service. To answer, drag the appropriate scenario from the column on the left to its cloud service on the right. Each scenario may be used only once.

NOTE: Each correct selection is worth one point.

Answer Area

Scenarios

Custom web and mobile application securely connected to an on-premises data store

Exchange Online integrated with on-premises Skype for Business Server

Server-based workloads on a virtual machine that are connected to an on-premises network

Service

Software as a service (SaaS)

Platform as a service (PaaS)

Infrastructure as a service (IaaS)

Scenario

Scenario

Scenario

Scenario

- A. Mastered
- B. Not Mastered

Answer: A

Explanation:

References:

<https://docs.microsoft.com/en-us/office365/enterprise/hybrid-cloud-overview>

NEW QUESTION 65

You are the Microsoft 365 administrator for a company.

Your company plans to open a new office in the United Kingdom.

You need to provide penetration test and security assessment reports for the new office. Where can you locate the required reports?

- A. Data Governance page of the Security and Compliance portal.
- B. Compliance Manager page of the Services Trust portal
- C. Data Loss Prevention page of the Security and Compliance portal
- D. Regional Compliance page of the Services Trust portal

Answer: D

NEW QUESTION 69

You need to ensure that all users in your tenant have access to the earliest release of updates in Microsoft 365. You set the organizational release preference to Standard release.

Select the correct answer if the underlined text does not make the statement correct. Select "No change is needed" if the underlined text makes the statement correct.

- A. Targeted release for entire organization
- B. No change is needed
- C. Targeted release for select users
- D. First release

Answer: A

Explanation:

Standard release is the default setting. It implements updates on final release rather than early release.

First release is now called Targeted release. Targeted release is the early release of updates for early feedback. You can choose to have individuals or the entire organization receive updates early.

<https://docs.microsoft.com/en-us/office365/admin/manage/release-options-in-office-365?view=o365-worldwide>

NEW QUESTION 71

You are a Microsoft 365 administrator.

You need to implement the appropriate features for each scenario.

What should you implement? To answer, select the appropriate options in the answer area. NOTE: Each correct selection is worth one point.

Scenario

Restrict access to Microsoft Outlook by using a PIN.

Mobile application protection policy

Device configuration policy

Secure members of the Global Administrators group by using dynamic risk profiles.

Microsoft Azure AD Identity Protection

Microsoft Azure AD Conditional Access

Microsoft Azure AD Privilege Identity Management

Secure admin roles by requiring approvals.

Microsoft Azure AD Identity Protection

Microsoft Azure AD Privilege Identity Management

Microsoft Azure AD Domain Services

- A. Mastered
- B. Not Mastered

Answer: A

Explanation:

References:  
<https://docs.microsoft.com/en-us/exchange/clients-and-mobile-in-exchange-online/outlook-for-ios-and-android/s> <https://docs.microsoft.com/en-us/azure/active-directory/identity-protection/overview> <https://docs.microsoft.com/en-us/azure/active-directory/privileged-identity-management/pim-configure>

NEW QUESTION 75

A company has offices in multiple regions. The company has a Microsoft 365 subscription. The company is developing a line-of-business (LOB) app. The app must meet the following requirements.

- Ensure availability regardless of an employee’s location.
- Track the devices on which the app is installed by using Microsoft cloud services.
- Minimize costs.

What should you do?

- A. Copy the app to Microsoft OneDrive
- B. Allow employees to download and install the app from One Drive.
- C. Deploy the app to all devices by using Microsoft Intune.
- D. Copy the app to local server
- E. Allow employees to download and install the app from the servers.
- F. Deploy the app to all devices by using group policy.

Answer: B

NEW QUESTION 80

A company is evaluating Microsoft Viva. You need to recommend the appropriate Microsoft Viva modules. Which module should you use? To answer, drag the appropriate modules to the correct features. Each module may be used once, more than once, or not at all. You may need to drag the split bar between panes or scroll to view content  
NOTE: Each correct selection is worth one point.

Modules

Insights

Topics

Connections

Personnel

Answer Area

Feature

Provides a unified app in Microsoft Teams that includes Workplace Analytics, MyAnalytics and Glint.

Uses artificial intelligence (AI) to identify knowledge and experts in a company and displays them in Microsoft Teams.

Module

- A. Mastered
- B. Not Mastered

Answer: A

Explanation:



**Modules**  

Insights
Topics
Connections

**Answer Area**  

Feature	Module
Provides a unified app in Microsoft Teams that includes Workplace Analytics, MyAnalytics and Glint.	Insights
Uses artificial intelligence (AI) to identify knowledge and experts in a company and displays them in Microsoft Teams.	Learning

#### NEW QUESTION 81

A company needs to protect documents and emails by automatically applying classifications and labels. You must minimize costs. What should the company implement? To answer, select the appropriate option in the answer area.

The company should implement

	▼
Azure Information Protection P1	
Azure Information Protection P2	
Microsoft 365 E3	

- A. Mastered
- B. Not Mastered

**Answer:** A

**Explanation:**

The company should implement

	▼
Azure Information Protection P1	
Azure Information Protection P2	
Microsoft 365 E3	

#### NEW QUESTION 82

You are the Microsoft 365 administrator for a company. You need to ensure that users receive a warning message if they select links in emails that might be unsafe. What should you do?

- A. Use Windows PowerShell to install the latest antimalware engine updates
- B. Enable Microsoft Office 365 Advanced Threat Protection
- C. Use the Microsoft Exchange Admin Center to configure a new spam-filter policy
- D. Use the Microsoft Exchange Admin Center to create a new antimalware policy

**Answer:** B

**Explanation:**

References:  
<https://docs.microsoft.com/en-us/office365/securitycompliance/atp-safe-links>

#### NEW QUESTION 85

Your company has a Microsoft Office 365 subscription. You need to co-author files with other users. Which tool should you use?

- A. Microsoft SharePoint Online
- B. Microsoft Skype for Business Online
- C. Microsoft Office Delve
- D. Microsoft Exchange Online

**Answer:** A

#### NEW QUESTION 90

A company is migrating to Microsoft 365. The company is evaluating work management features in Microsoft 365. You need to recommend the appropriate Microsoft 365 services.

Which services should you recommend? To answer, drag the appropriate services to the correct features. Each service may be used once, more than once, or not at all. You may need to drag the split bar between panes or scroll to view content.  
 NOTE: Each correct selection is worth one point.

- A. Mastered
- B. Not Mastered

Answer: A

Explanation:

#### NEW QUESTION 95

A company is planning to implement Microsoft 365. The company has not purchased licenses from Microsoft. You need to recommend a licensing solution. Which licensing solution should you recommend?

- A. Add-on user subscription licenses
- B. Full user subscription licenses
- C. From Software Assurance (SA) user subscription licenses
- D. Step-up user subscription licenses

Answer: D

#### NEW QUESTION 97

A company has an on-premises application server. The company wants to use some of the services in Microsoft 365 with the on-premises application server. You need to choose a cloud deployment model that meets the requirement. What should you choose?

- A. Private
- B. Hybrid
- C. Public

Answer: B

#### NEW QUESTION 100

A company is considering using Microsoft cloud services. You need to determine which mobility features Microsoft Intune supports. Which Three features does Microsoft Intune support? Each correct answer presents a complete solution. NOTE: Each correct selection is worth one point.

- A. It provides mobile device management (MDM) capabilities.
- B. It upgrades operating systems on mobile phone devices.
- C. It deploys operating systems to mobile phone devices.
- D. It deploys applications to mobile phone devices.
- E. It provides mobile application management (MAM) capabilities.

Answer: ADE

#### NEW QUESTION 105

A company plans to deploy Microsoft 365. You need to identify the appropriate collaboration solution for each task. Which solution should you choose for each task? To answer, select the appropriate options in the answer area. NOTE: Each correct selection is worth one point.

Task	Service
Host meetings with employees and guests.	<div>▼</div> <div>Microsoft Teams</div> <div>Azure DevOps</div> <div>SharePoint Online</div> <div>Dynamics 365</div>
Deploy a web page for a team or project.	<div>▼</div> <div>Microsoft Teams</div> <div>SharePoint Online</div> <div>Dynamics 365</div> <div>Microsoft 365 apps</div>
Manage team and work progress on a project.	<div>▼</div> <div>Microsoft Teams</div> <div>SharePoint Online</div> <div>Microsoft Planner</div> <div>Dynamics 365</div>

- A. Mastered  
 B. Not Mastered

Answer: A

Explanation:

Task	Service
Host meetings with employees and guests.	<div>▼</div> <div>Microsoft Teams</div> <div>Azure DevOps</div> <div>SharePoint Online</div> <div>Dynamics 365</div>
Deploy a web page for a team or project.	<div>▼</div> <div>Microsoft Teams</div> <div>SharePoint Online</div> <div>Dynamics 365</div> <div>Microsoft 365 apps</div>
Manage team and work progress on a project.	<div>▼</div> <div>Microsoft Teams</div> <div>SharePoint Online</div> <div>Microsoft Planner</div> <div>Dynamics 365</div>

#### NEW QUESTION 108

Instructions: For each of the following statements, select Yes if the statement is true. Otherwise, select No.  
 NOTE: Each correct selection is worth one point.



Statements	Yes	No
Microsoft Endpoint Manager includes the Intune Connector for Azure Active Directory.	<input type="radio"/>	<input type="radio"/>
Microsoft Endpoint Manager includes the Intune Exchange connector.	<input type="radio"/>	<input type="radio"/>
Microsoft Endpoint Manager can manage and monitor mobile devices.	<input type="radio"/>	<input type="radio"/>

- A. Mastered  
B. Not Mastered

Answer: A

Explanation:  
Graphical user interface, text, application, email Description automatically generated

NEW QUESTION 113

A company uses Microsoft 365 and Windows 10.  
You need to identify which servicing tools the company should use for Windows 10.  
Which servicing tool should you choose for each description? To answer, drag the appropriate servicing tools to the correct servicing tool descriptions. Each servicing tool may be used once, more than once, or not at all. You may need to drag the split bar between panes or scroll to view content.  
NOTE: Each correct selection is worth one point.

Servicing Tools

Windows Update

Microsoft Endpoint Configuration Manager

Answer Area

Servicing tool description

Limited control over feature updates and the ability to manually defer updates

Full control over feature updates and multiple deployment options

Servicing tool

- A. Mastered  
B. Not Mastered

Answer: A

Explanation:

Servicing Tools

Windows Update

Microsoft Endpoint Configuration Manager

Answer Area

Servicing tool description

Limited control over feature updates and the ability to manually defer updates

Full control over feature updates and multiple deployment options

Servicing tool

Windows Update

Microsoft Endpoint Configuration Manager

NEW QUESTION 117

You are the Microsoft 365 administrator for a company.  
You need to find all general availability features for SharePoint Online.  
Which two options should you select on the Microsoft 365 Roadmap page? To answer, select the appropriate options in the answer area.  
NOTE: Each correct selection is worth one point.

Answer Area

Microsoft 365 Roadmap

Get the Latest Updates

Microsoft 365 is a complete, intelligent solution, including Office 365, Windows 10, and Enterprise Mobility + Security, that empowers everyone to be creative and work together, securely.

Search for a product, release or specific update

Filters | Clear all

Products

☐ Enterprise Mobility + Security
 ☐ Office 365
 ☒ Windows 10

Platform

Cloud Instance

Showing 480 updates:

In Development

Launched

Excel

OneDrive for Business

Outlook

SharePoint

Microsoft Teams

Microsoft Forms

Planner

StaffHub

Sway

Compliance

Yammer

Access

Exchange

Project

Microsoft Stream

Groups

Word

OneNote

Bookings

Office 365 Information Protection

Windows

In development

184

Rolling out

50

Launched

296

Description

Status

Products

Release

Live events in Yammer

To

Yammer

December 19, 2019

Download Share RSS

A. Mastered  
 B. Not Mastered

Answer: A

**Explanation:**

References:

<https://www.microsoft.com/en-us/microsoft-365/roadmap?filters=Launched%2CWindows%2COnline%2CO365>

**NEW QUESTION 118**

Instructions: For each of the following statements, select Yes if the statement is true. Otherwise, select No.

NOTE: Each correct selection is worth one point.

Statements	Yes	No
The direct bill Cloud Solution Provider (CSP) model allows customers to purchase licenses directly from Microsoft.	<input type="radio"/>	<input type="radio"/>
The direct bill Cloud Solution Provider (CSP) model allows a single organizational point of contact for technical support.	<input type="radio"/>	<input type="radio"/>
The direct bill Cloud Solution Provider (CSP) model allows a single organizational point of contact for billing.	<input type="radio"/>	<input type="radio"/>

A. Mastered  
 B. Not Mastered

Answer: A

**Explanation:**

Graphical user interface, text, application Description automatically generated

**NEW QUESTION 121**

A company plans to purchase Microsoft 365 Enterprise licenses.

Which two options can you use? Each correct answer presents a complete solution. NOTE: Each correct selection is worth one point.

A. through a Cloud Solution Provider (CSP)  
 B. from the Microsoft website using a corporate credit card  
 C. from the Microsoft retail store  
 D. with an Enterprise Agreement (EA) subscription from Microsoft

Answer: AD

**Explanation:**

References:

<https://docs.microsoft.com/en-us/microsoft-365/business/get-microsoft-365-business> <https://www.microsoft.com/en-us/licensing/licensing-programs/enterprise?activetab=enterprise-tab%3aprimar>

Passing Certification Exams Made Easy

visit - <https://www.2PassEasy.com>

### NEW QUESTION 122

You manage point-of-sale terminals that run Windows 7.

You mint upgrade the terminals to Windows 10. Terminals will not be upgraded again for at least five years. You have the following requirements:

- Perform consistent scheduling of upgrades across all devices.
- Minimize costs.

You need to prepare for the upgrades.

What should you use? To answer, select the appropriate options in the answer area. NOTE: Each correct selection n worth one point.

Option	Value
Windows 10 version	<div> <div></div> <div> Windows 10 Pro  Windows 10 Home  Windows 10 Enterprise  Windows 10 Enterprise LTS8 </div> </div>
Servicing channel	<div> <div></div> <div> Semi-annual channel  Long-term servicing channel  Semi-annual channel (targeted)  Insider </div> </div>
Servicing tool	<div> <div></div> <div> Microsoft Intune  Windows Autopilot  Windows Server Update Services  System Center Configuration Manager </div> </div>

- A. Mastered  
B. Not Mastered

**Answer:** A

#### Explanation:

References:

<https://docs.microsoft.com/en-us/windows/deployment/update/waas-overview#long-term-servicing-channel> <https://docs.microsoft.com/en-us/windows/deployment/update/waas-overview#servicing-tools>

### NEW QUESTION 123

A company has Microsoft Surface devices that run Windows 10. The company plans to deploy devices by using Windows AutoPilot.

You need to import a CSV file to ensure that the devices are ready for deployment.

In the Microsoft 365 Device Management portal, which two blades should you use? To answer, select the appropriate options in the dialog box in the answer area.

NOTE: Each correct selection is worth one point.



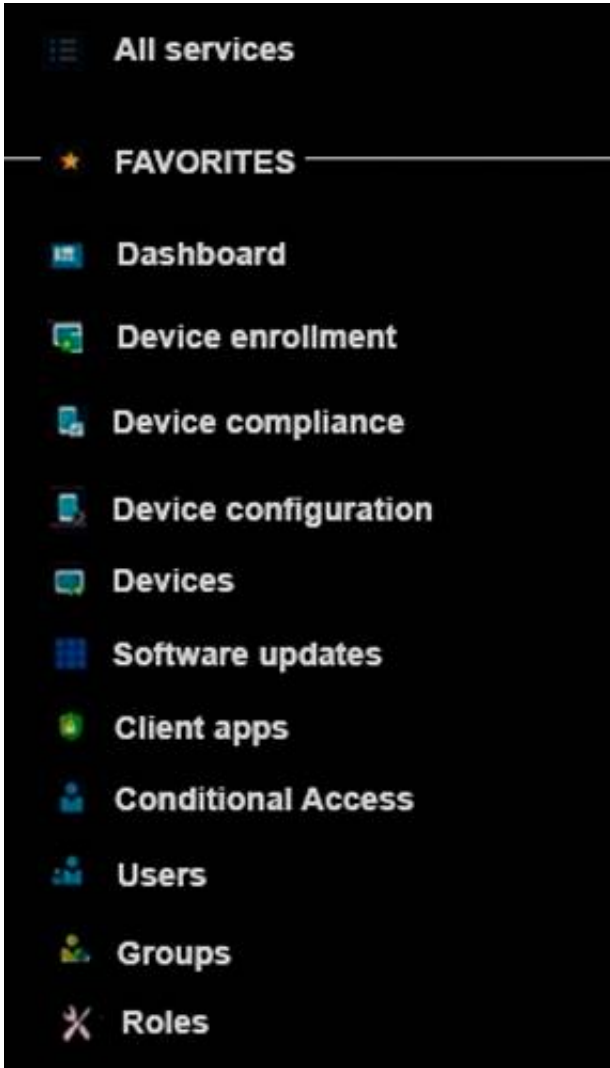

- A. Mastered
- B. Not Mastered

Answer: A

Explanation:

References:  
<https://docs.microsoft.com/en-us/intune/enrollment-autopilot>

NEW QUESTION 127

You are an IT director that is evaluating the capabilities of Microsoft Endpoint Manager. You need to present the capabilities to key stakeholders. Which three capabilities should you present to the stakeholders? Each correct answer presents a complete solution. NOTE: Each correct selection is worth one point.

- A. Deploy on- premises desktop apps.
- B. Monitor on-premises servers.
- C. Manage cloud-based mobile devices.
- D. Report on cloud-based security event information.
- E. Set up and preconfigure new Windows devices.

Answer: BCE

NEW QUESTION 130

Instructions: For each of the following statements, select Yes if the statement is true. Otherwise, select No. NOTE: Each correct selection is worth one point.

	Yes	No
Microsoft 365 applications can access Dynamics 365 data by using existing connectors.	<input type="radio"/>	<input type="radio"/>
Microsoft Teams allows you to access customer information in Dynamics 365.	<input type="radio"/>	<input type="radio"/>
Power Platform allows you to build custom apps to automate processes in Dynamics 365.	<input type="radio"/>	<input type="radio"/>

- A. Mastered
- B. Not Mastered

Answer: A

Explanation:

A screenshot of a computer Description automatically generated with medium confidence

Box 1: Yes  
The Microsoft Dataverse connector is used to connect to Dynamics 365 data  
Box 2: Yes  
Microsoft Teams users get license-free access to Dynamics 365 data  
Box 3: Yes  
The Microsoft Dataverse connector allows you to connect Power Platform to Dynamic 365 data

NEW QUESTION 131

A company plans to send surveys and polls to their customers.  
The company needs to view responses and collect feedback from the surveys and polls You need to identify which product meets the requirements.  
Which product should you select?

- A. Microsoft Forms
- B. Microsoft Teams
- C. SharePoint
- D. Microsoft 365 Apps for enterprise

Answer: B

NEW QUESTION 133

You need to ensure that all users in your tenant have access to the earliest release of updates in Microsoft 365. Which organizational release option should you use? To answer select the appropriate option in the answer area.

Answer Area

Use the

- A. Mastered
- B. Not Mastered

Answer: A

Explanation:

Answer Area

Use the

NEW QUESTION 134

A company is investigating the service-level agreements (SLAS) provided by Microsoft 365. For each of the following statements, select Yes if the statement is true. Otherwise, select No. NOTE: Each correct selection is worth one point.

Statements	Yes	No
The SLA commits to providing 100% uptime and email delivery.	<input type="radio"/>	<input type="radio"/>
Every Microsoft 365 application has an individual SLA commitment.	<input type="radio"/>	<input type="radio"/>
Microsoft offers a service credit if the SLA is not upheld.	<input type="radio"/>	<input type="radio"/>

- A. Mastered
- B. Not Mastered

Answer: A

Explanation:

NO: Microsoft 365 provides service-level agreements (SLAs) that describe Microsoft's commitments for uptime and connectivity for its online services. The SLAs vary depending on the service and plan, but generally they offer a 99.9% monthly uptime guaran1t.ee  
The SLA for Exchange Online, which is the email service in Microsoft 365, states that Microsoft will provide at least 99.9% availability of email delivery within one min4u.tHe owever, this is an average over a month and not for any one email message. If there is an average delay of greater than 10 minutes over a month, then Microsoft will consider it a breach of the SLA4.  
NO: Microsoft 365 provides service-level agreements (SLAs) that describe Microsoft's commitments for uptime and connectivity for its online services. The SLAs vary depending on the service and plan, but generally they offer a 99.9% monthly uptime guaran1t.ee  
However, not every Microsoft 365 application has an individual SLA commitment. Some applications are grouped together under a single SLA, such as Office 365 apps (Word, Excel, PowerPoint, etc.), SharePoint Online, OneDrive for Business, etc.1. Other applications have their own separate SLAs, such as Dynamics 365 apps (Sales, Customer Service, Marketing, etc.), Azure Active Directory Premium P1/P2 plans1, etc.  
YES: Microsoft offers a service credit if the SLA is not upheld for Microsoft Online Services such as Azure, Dynamics 365, Office 365, and Intune. The service credit is prorated based on the service affected and the duration of the outage1.

NEW QUESTION 137

You use Microsoft Business Products.  
When you try to create a support request, you receive the following message: You don't have permission to access this page or perform this action.

You need to determine the cause of the error message. What is the cause?

- A. Your password is expired
- B. Your account is disabled
- C. Your company does not have Premier support
- D. Your account is not a member of the global admin role

**Answer:** D

**Explanation:**

References:

<https://docs.microsoft.com/en-us/office365/admin/add-users/about-admin-roles?view=o365-worldwide>

#### NEW QUESTION 139

For each of the following statements, select Yes if the statement is true. Otherwise, select No. NOTE: Each correct selection is worth one point.

Statement	Yes	No
Azure virtual machine is an infrastructure as a service (IaaS) solution.	<input type="radio"/>	<input type="radio"/>
SharePoint Online is an IaaS solution.	<input type="radio"/>	<input type="radio"/>
Microsoft Teams is an IaaS solution.	<input type="radio"/>	<input type="radio"/>

- A. Mastered
- B. Not Mastered

**Answer:** A

**Explanation:**

Statement	Yes	No
Azure virtual machine is an infrastructure as a service (IaaS) solution.	<input checked="" type="radio"/>	<input type="radio"/>
SharePoint Online is an IaaS solution.	<input type="radio"/>	<input checked="" type="radio"/>
Microsoft Teams is an IaaS solution.	<input type="radio"/>	<input checked="" type="radio"/>

#### NEW QUESTION 140

External clients schedule meetings with members of a company.

A user asks for help creating two meetings. The user wants to send a link to clients that will allow them to schedule the meetings with the user.

You need to provide a solution for the user and the clients. Which application should you recommend?

- A. Microsoft Teams
- B. Microsoft Outlook
- C. Microsoft Bookings
- D. Microsoft Forms

**Answer:** C

**Explanation:**

Microsoft Bookings is an application that allows you to create and send a link to clients that will let them schedule meetings with you. You can customize appointment details, booking requirements, and specify service providers to streamline the booking experience for you and your customers2. Microsoft Bookings is integrated with your Microsoft 365 calendar to help your customers quickly find available times and avoid double-booking2.

#### NEW QUESTION 142

Instructions: For each of the following statements, select Yes if the statement is true. Otherwise, select No.

NOTE: Each correct selection is worth one point.

Statements	Yes	No
You can track the activity of files that are accessed in a SharePoint team site.	<input type="radio"/>	<input type="radio"/>
A SharePoint team site is created when you create a Microsoft 365 group.	<input type="radio"/>	<input type="radio"/>
A Microsoft 365 group is created when you create a new SharePoint team site.	<input type="radio"/>	<input type="radio"/>



- A. Mastered
- B. Not Mastered

**Answer:** A

**Explanation:**

Graphical user interface, text, application, email Description automatically generated

**NEW QUESTION 144**

You are the Microsoft 365 administrator for a company.

All staff must use Microsoft Outlook to access corporate email. When users access Outlook on mobile devices, they must use a PIN to open the application.

You need to implement a Microsoft Intune policy to enforce the security requirements. Which policy should you use?

- A. device compliance
- B. device configuration
- C. app protection
- D. app configuration

**Answer:** C

**Explanation:**

References:

<https://docs.microsoft.com/en-us/intune/app-protection-policy>

**NEW QUESTION 148**

: 136 HOTSPOT

For each of the following statements, select Yes if the statement is true. Otherwise, select No. NOTE: Each correct selection is worth one point.

Statement	Yes	No
Using OneDrive for Business as a target for backups is an example of platform as a service (PaaS).	<input type="radio"/>	<input type="radio"/>
Using OneDrive for Business in Office 365 Excel Online to open Excel files is an example of software as a service (SaaS).	<input type="radio"/>	<input type="radio"/>

- A. Mastered
- B. Not Mastered

**Answer:** A

**Explanation:**

Statement	Yes	No
Using OneDrive for Business as a target for backups is an example of platform as a service (PaaS).	<input type="radio"/>	<input checked="" type="radio"/>
Using OneDrive for Business in Office 365 Excel Online to open Excel files is an example of software as a service (SaaS).	<input checked="" type="radio"/>	<input type="radio"/>

**NEW QUESTION 150**

Instructions: For each of the following statements, select Yes if the statement is true. Otherwise, select No.

NOTE: Each correct selection is worth one point.

Statements	Yes	No
Microsoft Service Trust Portal provides audit reports.	<input type="radio"/>	<input type="radio"/>
Microsoft Service Trust Portal provides penetration test reports.	<input type="radio"/>	<input type="radio"/>
Microsoft Service Trust Portal allows for the configuration of conditional access policies.	<input type="radio"/>	<input type="radio"/>

- A. Mastered

B. Not Mastered

**Answer:** A

**Explanation:**

Yes, Yes, No

"Pen Test and Security Assessments; These reports provide the results of activities performed during penetration testing and records of the security tests."  
<https://servicetrust.microsoft.com/viewpage/PenTest>

#### NEW QUESTION 152

A company uses Microsoft 365.

The company needs information about the collaboration patterns that impact employee productivity.

You need to identify the solution that meets the requirement. Which solution should you choose?

- A. MyAnalytics
- B. Workplace Analytics
- C. Microsoft 365 admin center
- D. Azure Analytics

**Answer:** B

#### NEW QUESTION 157

Instructions: For each of the following statements, select Yes if the statement is true. Otherwise, select No. NOTE: Each correct selection is worth one point.

##### Answer Area

Statements	Yes	No
Conditional access policies allow you to require multi-factor authentication for Microsoft Azure management tasks.	<input type="radio"/>	<input type="radio"/>
Conditional access policies allow you to require multi-factor authentication for users who have administrative roles.	<input type="radio"/>	<input type="radio"/>
Configuration of app specific settings require devices to be managed by an organization.	<input type="radio"/>	<input type="radio"/>

- A. Mastered
- B. Not Mastered

**Answer:** A

**Explanation:**

##### Answer Area

Statements	Yes	No
Conditional access policies allow you to require multi-factor authentication for Microsoft Azure management tasks.	<input checked="" type="radio"/>	<input type="radio"/>
Conditional access policies allow you to require multi-factor authentication for users who have administrative roles.	<input checked="" type="radio"/>	<input type="radio"/>
Configuration of app specific settings require devices to be managed by an organization.	<input checked="" type="radio"/>	<input type="radio"/>

#### NEW QUESTION 161

For each of the following statements, select Yes if the statement is true. Otherwise, select No. NOTE: Each correct selection is worth one point.

Statement	Yes	No
Microsoft MyAnalytics supports Microsoft PowerBI templates.	<input type="radio"/>	<input type="radio"/>
Microsoft MyAnalytics supports Microsoft Outlook add-ins.	<input type="radio"/>	<input type="radio"/>
Microsoft Workplace Analytics supports weekly email digests.	<input type="radio"/>	<input type="radio"/>

- A. Mastered
- B. Not Mastered

**Answer:** A

**Explanation:**

References:

<https://docs.microsoft.com/en-us/workplace-analytics/myanalytics/use/add-in> <https://docs.microsoft.com/en-us/workplace-analytics/myanalytics/mya-landing-page>  
<https://docs.microsoft.com/en-us/workplace-analytics/index-orig>

NEW QUESTION 166

You are the Microsoft 365 administrator for a company.  
You need to track scheduled maintenance events in Microsoft 365 admin center. Where can you track these events?

- A. Reports
- B. Support
- C. Service Health
- D. Message Center

Answer: D

Explanation:

<https://docs.microsoft.com/en-us/office365/servicedescriptions/office-365-platform-service-description/service>

NEW QUESTION 167

Instructions: For each of the following statements, select Yes if the statement is true. Otherwise, select No.  
NOTE: Each correct selection is worth one point.

	Yes	No
A company must have highly reliable internet in order to adopt Microsoft 365.	<input type="radio"/>	<input type="radio"/>
A company that wants to use a single license for users with desktop computers and mobile devices should use Microsoft 365 licensing.	<input type="radio"/>	<input type="radio"/>

- A. Mastered
- B. Not Mastered

Answer: A

Explanation:

Graphical user interface, text, application Description automatically generated

NEW QUESTION 171

A company plans to migrate to a hybrid cloud infrastructure.  
You need to determine where to manage the different features after the hybrid deployment is complete. Match each item to the location where it will be managed.  
To answer, drag the appropriate item from the column on the left to its location on the right. Each item may be used once, more than once, or not at all.  
NOTE: Each correct selection is worth one point.

Configuration locations	Option	
Microsoft 365 only	Configure multi-factor authentication for cloud services.	Configuration location
on-premises only	Configure email disclaimers.	Configuration location
both Microsoft 365 and on-premises	Configure compliance.	Configuration location
	Set frequency of Microsoft Office 365 updates.	Configuration location

- A. Mastered
- B. Not Mastered

Answer: A

Explanation:

References:  
<https://docs.microsoft.com/en-us/office365/securitycompliance/go-to-the-securitycompliance-center> <https://docs.microsoft.com/en-us/exchange/security-and-compliance/mail-flow-rules/disclaimers-signatures-foot> <https://www.itprotoday.com/email-and-calendaring/configure-email-disclaimer-exchange-server-2016>  
<https://docs.microsoft.com/en-us/office365/troubleshoot/administration/switch-channel-for-office-365>

NEW QUESTION 174

A company plan to deploy Microsoft 365 services.



You need to choose the appropriate cloud service for each requirement.

Which cloud service should you choose for each requirement? To answer, drag the appropriate cloud services to the correct requirements. Each cloud service may be used once, more than once, or not at all. You may need to drag the split bar between panes or scroll to view content.

NOTE: Each correct match is worth one point.

Cloud services	Requirement	Cloud service
Exchange Online		
Microsoft Teams	Users must be able to chat, host meetings, and make calls with internal and external users.	Cloud service
Yammer		
Microsoft Stream	Users must be able to create posts, tag people and communities, and use social tagging.	Cloud service

- A. Mastered
- B. Not Mastered

Answer: A

Explanation:

Cloud services	Requirement	Cloud service
Exchange Online		
Microsoft Teams	Users must be able to chat, host meetings, and make calls with internal and external users.	Microsoft Teams
Yammer		
Microsoft Stream	Users must be able to create posts, tag people and communities, and use social tagging.	Yammer

#### NEW QUESTION 176

You are the Microsoft Office 365 administrator for a company. The company has the following requirements:

- > Users must be able to use incompatible applications on a Windows 10 device.
- > Cloud-based applications must use the same credentials as on-premises applications.
- > Users must be prevented from copying company data from managed applications installed on unmanaged devices.

You need to determine which technologies should be used for each requirement.

Which technologies should be used? To answer, select the appropriate options in the answer area.

Requirement	Service
Users must be able to use incompatible applications on a Windows 10 device.	<div> <div>▼</div> <div> Windows Virtual Desktop  Azure AD Application Proxy  Azure AD Connect  Microsoft Intune </div> </div>
Cloud-based application must use the same credentials as on-premises applications.	<div> <div>▼</div> <div> Windows Virtual Desktop  Azure AD Application Proxy  Azure AD Connect  Microsoft Intune </div> </div>
Users must be prevented from copying company data from managed applications installed on unmanaged devices.	<div> <div>▼</div> <div> Windows Virtual Desktop  Azure AD Application Proxy  Azure AD Connect  Microsoft Intune </div> </div>

- A. Mastered
- B. Not Mastered

Answer: A

**Explanation:**

References:

<https://www.microsoft.com/en-us/microsoft-365/modern-desktop/enterprise/windows-virtual-desktop> <https://docs.microsoft.com/en-us/azure/active-directory/hybrid/whatis-azure-ad-connect> <https://docs.microsoft.com/en-us/intune/what-is-intune>

**NEW QUESTION 179**

A company is planning to use Microsoft Threat Protection.

The company needs to protect Windows 10 client computers from malicious viruses. The company also needs to identify unauthorized cloud apps that are used by end users.

You need to identify the Microsoft Threat Protection solutions that meet the requirements. Which two solutions should you choose? Each correct answer presents part of the solution. NOTE: Each correct selection is worth one point.

- A. Azure Advanced Threat Protection
- B. Microsoft Defender Advanced Threat Protection
- C. Office 365 Advanced Threat Protection
- D. Microsoft Cloud App Security

**Answer:** BD

**NEW QUESTION 180**

You are the network administrator of a company.

The Microsoft 365 tenant contains sensitive information. Employees must verify their identities when they sign into Microsoft 365 by providing information in addition to their Azure AD password.

You need to select the tools that employees can use to verify their identities.

Which two tools should you select? Each correct answer presents a complete solution. NOTE: Each correct selection is worth one point.

- A. Customer Lockbox for Office 365
- B. Microsoft Security Center
- C. Windows Hello for Business
- D. Microsoft Authenticator

**Answer:** CD

**Explanation:**

Two-step authentication can be implemented by using Windows Hello for Business or Microsoft Authenticator.

References:

<https://docs.microsoft.com/en-us/windows/security/identity-protection/hello-for-business/hello-manage-in-organ> <https://support.microsoft.com/en-us/help/4026727/microsoft-account-how-to-use-the-microsoft-authenticator-ap>

**NEW QUESTION 182**

Instructions: For each of the following statements, select Yes if the statement is true. Otherwise, select No. NOTE: Each correct selection is worth one point.

**Answer Area**

Statements	Yes	No
Microsoft Cloud App Security (MCAS) integrates with the Intelligent Security Graph to generate Microsoft Defender for Identity alerts.	<input type="radio"/>	<input type="radio"/>
Microsoft Cloud App Security (MCAS) integrates with Secure Score to report the available security features that may reduce risk.	<input type="radio"/>	<input type="radio"/>
Microsoft Cloud App Security (MCAS) integrates with Microsoft Power BI to automate a response when alerts are triggered.	<input type="radio"/>	<input type="radio"/>

- A. Mastered
- B. Not Mastered

**Answer:** A

**Explanation:**

**Answer Area**

Statements	Yes	No
Microsoft Cloud App Security (MCAS) integrates with the Intelligent Security Graph to generate Microsoft Defender for Identity alerts.	<input checked="" type="radio"/>	<input type="radio"/>
Microsoft Cloud App Security (MCAS) integrates with Secure Score to report the available security features that may reduce risk.	<input type="radio"/>	<input checked="" type="radio"/>
Microsoft Cloud App Security (MCAS) integrates with Microsoft Power BI to automate a response when alerts are triggered.	<input checked="" type="radio"/>	<input type="radio"/>

**NEW QUESTION 185**

Instructions: For each of the following statements, select Yes if the statement is true. Otherwise, select No. NOTE: Each correct selection is worth one point

Statements	Yes	No
Microsoft Endpoint Manager helps manage and monitor Android OS-based mobile devices.	<input type="radio"/>	<input type="radio"/>
Microsoft Endpoint Manager helps manage and monitor Windows 10 personal desktop computers.	<input type="radio"/>	<input type="radio"/>
Microsoft Endpoint Manager is used to manage company-owned devices only.	<input type="radio"/>	<input type="radio"/>

- A. Mastered
- B. Not Mastered

Answer: A

Explanation:

Statements	Yes	No
Microsoft Endpoint Manager helps manage and monitor Android OS-based mobile devices.	<input checked="" type="radio"/>	<input type="radio"/>
Microsoft Endpoint Manager helps manage and monitor Windows 10 personal desktop computers.	<input checked="" type="radio"/>	<input type="radio"/>
Microsoft Endpoint Manager is used to manage company-owned devices only.	<input checked="" type="radio"/>	<input type="radio"/>

#### NEW QUESTION 186

This question requires that you evaluate the underlined BOLD text to determine if it is correct. Microsoft 365 is a Platform as a service (PaaS). Review the underlined text. If it makes the statement correct, select "No change is needed." If the statement is incorrect, select the answer choice that makes the statement correct.

- A. Infrastructure as a service (IaaS)
- B. Windows as a service (WaaS)
- C. Software as a service (SaaS)
- D. No change is needed

Answer: C

Explanation:

Microsoft 365 is SaaS, which provides an online version of MS Office Suite (Office Web Apps) along with SharePoint Server, Exchange Server and Lync Server.

References:

<https://www.cmswire.com/cms/information-management/cloud-service-models-iaas-saas-paas-how-microsoft-of>

#### NEW QUESTION 188

A company uses Microsoft 365.

The company is considering using MyAnalytics. You need to identify the features of MyAnalytics.

What are two features of MyAnalytics? Each correct answer presents a complete solution. NOTE: Each correct selection is worth one point.

- A. suggestions in Microsoft Outlook to review outstanding tasks
- B. suggestions in Microsoft Teams to delay delivery of chat messages
- C. suggestions in Microsoft Outlook to delay delivery of emails
- D. suggestions in Teams to review outstanding tasks

Answer: AC

#### NEW QUESTION 192

For each of the following statements, select Yes if the statement is true. Otherwise, select No. NOTE: Each correct selection is worth one point.

Statement	Yes	No
Companies that have recently invested in hardware and software can use a hybrid cloud model.	<input type="radio"/>	<input type="radio"/>
Companies that have few on-premises resources can use a hybrid cloud model.	<input type="radio"/>	<input type="radio"/>

- A. Mastered



B. Not Mastered

Answer: A

Explanation:

Statement	Yes	No
Companies that have recently invested in hardware and software can use a hybrid cloud model.	<input checked="" type="radio"/>	<input type="radio"/>
Companies that have few on-premises resources can use a hybrid cloud model.	<input type="radio"/>	<input checked="" type="radio"/>

NEW QUESTION 194

A company plans to migrate to Microsoft 365. Corporate devices run Windows 7 or Windows 10. You must upgrade all devices to use Office 365 ProPlus and minimize costs.  
You need to standardize corporate device deployments.  
Which three actions should you perform? Each correct answer presents part of the solution. NOTE: Each correct selection is worth one point.

- A. Implement Windows AutoPilot
- B. Deploy policies by using Configuration Manager
- C. Upgrade all devices to Windows 10
- D. Deploy policies by using Microsoft Intune
- E. Instruct users to download and install a Windows Installer package for Office 365 ProPlus

Answer: ACD

NEW QUESTION 196

Instructions: For each of the following statements, select Yes if the statement is true Otherwise, select No NOTE: Each correct selection is worth one point.

Statements	Yes	No
You can deploy Microsoft 365 Apps for enterprise from a local source by using Configuration Manager.	<input type="radio"/>	<input type="radio"/>
You can deploy Microsoft 365 Apps for enterprise from the cloud by using the Office Deployment Tool.	<input type="radio"/>	<input type="radio"/>
You can deploy Microsoft 365 Apps for enterprise from a local source by using the Office Deployment Tool.	<input type="radio"/>	<input type="radio"/>

- A. Mastered
- B. Not Mastered

Answer: A

Explanation:

Statements	Yes	No
You can deploy Microsoft 365 Apps for enterprise from a local source by using Configuration Manager.	<input type="radio"/>	<input checked="" type="radio"/>
You can deploy Microsoft 365 Apps for enterprise from the cloud by using the Office Deployment Tool.	<input checked="" type="radio"/>	<input type="radio"/>
You can deploy Microsoft 365 Apps for enterprise from a local source by using the Office Deployment Tool.	<input checked="" type="radio"/>	<input type="radio"/>

NEW QUESTION 199

A company is evaluating the licenses that are available in Microsoft 365. The company needs to minimize licensing costs.  
Match each license to its requirement. To answer, drag the appropriate license from the column on the left to its requirement on the right. Each license may be used once, more than once, or not at all.  
NOTE: Each correct match is worth one point.

## Licenses

Microsoft 365 Business Premium

Microsoft 365 E3

Microsoft 365 E5

Microsoft 365 F3

## Answer Area

### Requirement

- Users require a mailbox and will use Office web and mobile apps to access the mailbox.
- Users require a mailbox and will use Outlook and mobile apps to access the mailbox.
- Users require a Windows 10 Enterprise license and a mailbox. They will use Outlook to access the mailbox.
- Users require a Windows 10 Enterprise license, a phone system license, and a mailbox. They will use Outlook to access the mailbox.

### License

License

License

License

License

- A. Mastered
- B. Not Mastered

Answer: A

### Explanation:

## Licenses

Microsoft 365 Business Premium

Microsoft 365 E3

Microsoft 365 E5

Microsoft 365 F3

## Answer Area

### Requirement

- Users require a mailbox and will use Office web and mobile apps to access the mailbox.
- Users require a mailbox and will use Outlook and mobile apps to access the mailbox.
- Users require a Windows 10 Enterprise license and a mailbox. They will use Outlook to access the mailbox.
- Users require a Windows 10 Enterprise license, a phone system license, and a mailbox. They will use Outlook to access the mailbox.

### License

Microsoft 365 F3

Microsoft 365 Business Premium

Microsoft 365 E3

Microsoft 365 E5

### NEW QUESTION 201

A company is evaluating Microsoft 365.

You need to identify the collaboration features of OneDrive.

What are two collaboration features of OneDrive? Each correct answer presents part of the solution. NOTE: Each correct selection is worth one point.

- A. Inviting external users to an online meeting.
- B. Chatting with multiple users.
- C. Coauthoring of supported documents.
- D. Sharing files with external users.

Answer: CD

### NEW QUESTION 204

You deploy Enterprise Mobility + Security E5 and assign Microsoft 365 licenses to all employees. Employees must not be able to share documents at forward emails that contain sensitive information outside the company.

You need to enforce the file sharing restrictions. What should you do?

- A. Use Microsoft Azure Information Protection to define a labe
- B. Associate the label with an Azure Rights Management template that prevents the sharing of files or emails that are marked with the label.
- C. Create a Microsoft SharePoint Online content type named Sensitivity Apply the content type to other content types in Microsof
- D. 356 a Microsoft Azure Rights Management template that prevents the sharing of any content where the Sensitivity column value is set to Sensitive.
- E. Use Microsoft Azure Information Rights Protection to define a labe
- F. Associate the label with an Active Directory Rights Management template that prevents the sharing of files or emails that are marked with the label.
- G. Create a label named Sensitiv
- H. Apply a Data Layer Protection policy that notifies users when their document contains personally identifiable information (PII).

Answer: A

### Explanation:

<https://docs.microsoft.com/en-us/azure/information-protection/what-is-azure-rms>

### NEW QUESTION 208

A company is evaluating Microsoft 365.

Select the answer that correctly completes the sentence.

Answer Area

The modules that are named Connections, Insights, Learning, and Topics are part of

- A. Mastered
- B. Not Mastered

Answer: A

Explanation:

The modules that are named Connections, Insights, Learning, and Topics are part of

NEW QUESTION 213

Your company uses Microsoft 365 with a business support plan.  
You need to identify Service Level Agreements (SLAs) from Microsoft for the support plan.  
What response can you expect for each event type? To answer, drag the appropriate responses to the correct event types. Each response may be used once, more than once, or not at all. You may need to drag the split bar between panes or scroll to view content.  
NOTE: Each correct selection is worth one point.

Answer Area		
Response	Event type	Response
<input type="text" value="continuously with a one-hout response time"/>	Critical	<input type="text"/>
<input type="text" value="during business hours with no commitment for response time"/>	High	<input type="text"/>
<input type="text" value="continuously with no commitment for response time"/>	Noncritical	<input type="text"/>
<input type="text" value="continuously with a next-day response time"/>		

- A. Mastered
- B. Not Mastered

Answer: A

Explanation:

References:  
<https://docs.microsoft.com/en-us/office365/servicedescriptions/office-365-platform-service-description/support>

NEW QUESTION 214

You implement Compliance Manager.  
You need to retrieve status information for a control task.  
Which two options can you use? To answer, select the appropriate options in the answer area. NOTE: Each correct selection is worth one point.



[Back To Dashboard](#)

Export to Excel

Lamna Healthcare Company Office 365

GDPR

50/114

In Progress

14/11/2018

270

Group Name

Product

Assessment

Assessed Controls

44% Assessed

Status

Last Modified

Compliance

Office 365 in-Scope Cloud Services

Microsoft Managed Controls

Conditions for collection and processing

5/5 Assessed

PII sharing, transfer, and disclosure

8/8 Assessed

Privacy by design and by default

3/3 Assessed

Rights of PII principals

1/1 Assessed

Security

32/32 Assessed

Customer Managed Controls

Conditions for collection and processing

1/7 Assessed

- A. Mastered
- B. Not Mastered

Answer: A

Explanation:  
References: <https://content.cloudguides.com/guides/Compliance%20Manager>

NEW QUESTION 219

You are the Microsoft 365 administrator for a company.  
Which two admin roles can purchase more licenses? Each correct answer presents a complete solution. NOTE: Each correct selection is worth one point.

- A. service administrator
- B. user management administrator
- C. global administrator
- D. billing administrator

Answer: CD

Explanation:  
References:  
<https://docs.microsoft.com/en-us/office365/admin/subscriptions-and-billing/buy-licenses?view=o365-worldwide>

NEW QUESTION 221

You have a hybrid environment that includes Microsoft Azure AD. On-premises applications use Active Directory Domain Services (AD DS) for authentication. You need to determine which authentication methods to use.  
Match each feature to its authentication source. To answer, drag the appropriate authentication sources from the column on the left to the client features on the right. Each authentication source may be used once, more than once, or not at all.  
NOTE: Each correct selection is worth one point.

Authentication sources

Client feature

Authentication sources

AD DS only

Log on to devices by using Windows Hello.

Authentication sources

Azure AD only

Log on to devices that are managed by Microsoft Intune.

Authentication sources

AD DS and Azure AD

Sign in to Outlook on the web by using multi-factor authentication.

Authentication sources

- A. Mastered
- B. Not Mastered

Answer: A

Explanation:

Authentication sources	Client feature	Authentication sources
AD DS only	Log on to devices by using Windows Hello.	AD DS and Azure AD
Azure AD only	Log on to devices that are managed by Microsoft Intune.	AD DS only
AD DS and Azure AD	Sign in to Outlook on the web by using multi-factor authentication.	Azure AD only

#### NEW QUESTION 222

You are the Microsoft 365 administrator for a company that uses only on-premises resources. The company does not have a private cloud.

You need to deploy cloud-based resources for the company that minimizes costs.

Which cloud models should you use? To answer, drag the appropriate cloud models to the correct requirements. Each cloud model may be used one, more than once, or not at all.

You may need to drag the split bar between panes or scroll to view content. NOTE: Each correct selection is worth one point.

Cloud models	Requirement	Cloud model
Private	Provide an on-demand sandbox environment.	
Public	Provide failover capabilities between local resources that you manage and resources in other regions.	
Hybrid	Deploy virtual machines that use proprietary peripheral devices.	

- A. Mastered
- B. Not Mastered

Answer: A

Explanation:

Cloud models	Requirement	Cloud model
Private	Provide an on-demand sandbox environment.	Public
Public	Provide failover capabilities between local resources that you manage and resources in other regions.	Hybrid
Hybrid	Deploy virtual machines that use proprietary peripheral devices.	Private

#### NEW QUESTION 225

A company experiences a Microsoft 365 outage that affects an entire region. You check the Service Health Dashboard and observe that the service is healthy. You need to find information in Service Health Dashboard that describes what happened during the outage. What should you use?

- A. Message Center
- B. incident closure summary
- C. Post-Incident Review (PIR)
- D. service request

Answer: C

Explanation:

References:

<https://docs.microsoft.com/en-us/office365/servicedescriptions/office-365-platform-service-description/service>

#### NEW QUESTION 230

A company uses Microsoft 365.

Users who are based on-premises must be able to reset their own passwords. The company plans to purchase Azure Active Directory (AD) licenses.

You need to identify the Azure AD licenses that meet this requirement.

Which two Azure AD licenses should you choose? Each correct answer presents a complete solution. NOTE: Each correct selection is worth one point.

- A. Azure AD Premium P2
- B. Azure AD Free
- C. Office 365 apps
- D. Azure AD Premium P1

**Answer:** AD

#### NEW QUESTION 234

A company is evaluating Microsoft cloud services.

You need to determine the licensing differences between Office 365 and Microsoft 365. Select the answer that correctly completes the sentence.

One of the primary differences between office 365 and Microsoft 365 can include licensing for

**Answer Area**



- A. Mastered
- B. Not Mastered

**Answer:** A

**Explanation:**

**Answer Area**



#### NEW QUESTION 238

Your company is evaluating the differences between deployments of Office 365 ProPlus and Office 2016. You need to determine the installation features of each deployment.

Which installation feature is unique to Office 365 ProPlus?

- A. Installation can be completed by using Click-to-Run.
- B. Installation can be completed by using System Center Configuration Manager.
- C. Installation is available in both 32-bit and 64-bit versions.
- D. Installation is on the user's local computer.

**Answer:** A

**Explanation:**

<http://blog.accessitautomation.com/office-2019-msi>

#### NEW QUESTION 241

What are three capabilities of Security and Compliance Center? Each correct answer presents a complete solution.

NOTE: Each correct selection is worth one point.

- A. Management of e-discovery cases, holds, and exports
- B. Assessment and auditing of Active Directory event logs
- C. Prevention of data loss for Exchange Online and SharePoint Online
- D. Assessment and auditing of on-premises firewall logs
- E. Threat management by using email filtering and anti-malware software

**Answer:** ACE

#### NEW QUESTION 246

You plan to deploy the Report Message add-in to Microsoft Outlook.

For each of the following statements, select Yes if the statement is true. Otherwise, select No. NOTE: Each correct selection is worth one point.



Statement	Yes	No
Use the Services & add-ins menu in the Microsoft 365 admin center to deploy the add-in.	<input type="radio"/>	<input type="radio"/>
Create a Microsoft Intune application policy to deploy the add-in.	<input type="radio"/>	<input type="radio"/>
Use Configuration Manager to deploy the add-in.	<input type="radio"/>	<input type="radio"/>

- A. Mastered  
 B. Not Mastered

Answer: A

Explanation:

Statement	Yes	No
Use the Services & add-ins menu in the Microsoft 365 admin center to deploy the add-in.	<input checked="" type="radio"/>	<input type="radio"/>
Create a Microsoft Intune application policy to deploy the add-in.	<input type="radio"/>	<input checked="" type="radio"/>
Use Configuration Manager to deploy the add-in.	<input type="radio"/>	<input checked="" type="radio"/>

#### NEW QUESTION 248

An organization has a Microsoft 365 subscription. You plan to implement multi-factor authentication. For each of the following statements, select Yes if the statement is true. Otherwise, select No.

NOTE: Each correct selection is worth one point.

Statement	Yes	No
After users are enrolled in multi-factor authentication, they must configure a second authentication factor the next time they sign in.	<input type="radio"/>	<input type="radio"/>
Enabling multi-factor authentication requires an additional subscription purchase.	<input type="radio"/>	<input type="radio"/>
Complete multi-factor authentication by using text messages, a smartphone app, or a phone call.	<input type="radio"/>	<input type="radio"/>

- A. Mastered  
 B. Not Mastered

Answer: A

Explanation:

References:

<https://docs.microsoft.com/en-us/office365/enterprise/multi-factor-authentication-for-your-office-365-dev-test-e>

#### NEW QUESTION 252

Your company has a Microsoft 365 subscription.

You need to implement security policies to ensure that sensitive data is protected.

Which tools should you use? To answer, drag the appropriate tools to the correct scenarios. Each tool may be used once, more than once, or not at all. You may need to drag the split bar between panes or scroll to view content.

NOTE: Each correct selection is worth one point.

Tools	Scenario	
Compliance Manager	Use the Microsoft Authenticator app to enable multi-factor authentication.	Tool
Identity and access management (IAM)	Classify documents to restrict permission to content.	Tool
Information rights management (IRM)	Use a dashboard for data-protection recommendations.	Tool
	Provide auditors and regulators with reports on data-protection status.	Tool

- A. Mastered  
B. Not Mastered

Answer: A

Explanation:

References:

<https://docs.microsoft.com/en-us/azure/information-protection/help-users>

<https://docs.microsoft.com/en-us/office365/securitycompliance/compliance-manager-overview#controls>

NEW QUESTION 256

A business acquaintance from another company sends you a document that is encrypted by Azure Information Protection (AIP). You are unable to open the document because the user account cannot be authenticated by the company's Azure Active Directory. You need to access the document. What should you do?

- A. Implement Azure Rights Management (RMS) for individuals for the user account.  
B. Implement Information Rights Management (IRM) for the Office application.  
C. Upgrade your account to include AIP for Office 365.

Answer: A

NEW QUESTION 261

For each of the following statements, select Yes if the statement is true. Otherwise, select No. NOTE: Each correct selection is worth one point.

Statement	Yes	No
You can purchase additional storage capacity on demand.	<input type="radio"/>	<input type="radio"/>
Cloud services are guaranteed to be available 100 percent of the time.	<input type="radio"/>	<input type="radio"/>
Cloud services use less energy than an enterprise on-premises datacenter.	<input type="radio"/>	<input type="radio"/>

- A. Mastered  
B. Not Mastered

Answer: A

Explanation:

Statement	Yes	No
You can purchase additional storage capacity on demand.	<input checked="" type="radio"/>	<input type="radio"/>
Cloud services are guaranteed to be available 100 percent of the time.	<input type="radio"/>	<input checked="" type="radio"/>
Cloud services use less energy than an enterprise on-premises datacenter.	<input checked="" type="radio"/>	<input type="radio"/>

NEW QUESTION 264

Instructions: For each of the following statements, select Yes if the statement is true. Otherwise, select No.

NOTE: Each correct selection is worth one point.

Statements	Yes	No
Microsoft Cloud App Security can integrate with multiple clouds	<input type="radio"/>	<input type="radio"/>
Microsoft Cloud App Security can be used to assess the regulatory compliance of cloud apps	<input type="radio"/>	<input type="radio"/>
Microsoft Cloud App Security can provide behavioral analytics and anomaly detection	<input type="radio"/>	<input type="radio"/>

- A. Mastered
- B. Not Mastered

**Answer:** A

**Explanation:**

Graphical user interface, text, application, email Description automatically generated

**NEW QUESTION 267**

Your organization plans to deploy a subscription-based licensing model of Microsoft Office to devices. You must use group policy to enforce Office application settings.

You need to deploy Office to the enterprise. Which version of Office should you deploy?

- A. Office 365 ProPlus
- B. Office Professional Plus 2016
- C. Office Online
- D. Office Home and Business 2016

**Answer:** A

**Explanation:**

References:  
<https://products.office.com/en-za/business/compare-more-office-365-for-business-plans>

**NEW QUESTION 271**

You are the Microsoft 365 administrator for a company. You deploy Windows 10 to all devices by using Windows Autopilot.

You need to ensure that employees can install Microsoft Office 365 ProPlus on their devices. What are two possible ways to achieve this goal? Each correct answer presents a part of a solution. NOTE: Each correct selection is worth one point.

- A. Use the self-install option on the Office 365 dashboard
- B. Download and install the Office ProPlus Windows Installer (MSI) package
- C. Enable auto-deployment of Office 365 apps for all devices
- D. Update the Windows AutoPilot deployment profile to include the Office 365 apps

**Answer:** AC

**Explanation:**

<https://answers.microsoft.com/en-us/msoffice/forum/all/msi-installer-for-office-365/69e0a0ae-ae67-4a6f-996c-c> <https://docs.microsoft.com/en-us/mem/intune/apps/apps-add-office365>

Deploy from a local source with Configuration Manager: Manage your deployment with Configuration Manager, and download and deploy Office from distribution points on your network.

Deploy from the cloud with the Office Deployment Tool: Manage your deployment with the ODT, and install Office on client devices directly from the Office CDN.

Deploy from a local source with the Office Deployment Tool: Manage your deployment with the ODT, and download and deploy Office from a local source on your network.

Self-install from the cloud: Manage your deployment from the Office portal and have your users install Office on their client devices directly from the portal.

**NEW QUESTION 276**

A company has Microsoft 365 and uses Microsoft Endpoint Manager.

You need to identify the endpoint management tool associated with each action.

Which tool should you identify for each action? To answer, drag the appropriate tools to the correct actions. Each tool may be used once, more than once, or not at all. You may need to drag the split bar between panes or scroll to view content.

NOTE: Each correct selection is worth one point.



Tools	Requirement	Tool
Software Center		
Configuration Manager	Manage employees' personal devices from the cloud.	
Microsoft Intune		
Autopilot	Manage power settings for on-premises servers.	

- A. Mastered  
 B. Not Mastered

Answer: A

Explanation:

Tools	Requirement	Tool
Software Center		
Configuration Manager	Manage employees' personal devices from the cloud.	Microsoft Intune
Microsoft Intune		
Autopilot	Manage power settings for on-premises servers.	Configuration Manager

#### NEW QUESTION 279

For each of the following statements, select Yes if the statement is true. Otherwise, select No. NOTE: Each correct selection is worth one point.

	Yes	No
Licensing through a Cloud Solution Provider (CSP) allows you to purchase nonperpetual software for on-premises use.	<input type="radio"/>	<input type="radio"/>
Licensing through a Cloud Solution Provider (CSP) allows you to receive a discount based on volume.	<input type="radio"/>	<input type="radio"/>
Licensing through a Cloud Solution Provider (CSP) allows you to receive technical support on your Microsoft services from a certified partner.	<input type="radio"/>	<input type="radio"/>

- A. Mastered  
 B. Not Mastered

Answer: A

Explanation:

	Yes	No
Licensing through a Cloud Solution Provider (CSP) allows you to purchase nonperpetual software for on-premises use.	<input type="radio"/>	<input checked="" type="radio"/>
Licensing through a Cloud Solution Provider (CSP) allows you to receive a discount based on volume.	<input checked="" type="radio"/>	<input type="radio"/>
Licensing through a Cloud Solution Provider (CSP) allows you to receive technical support on your Microsoft services from a certified partner.	<input checked="" type="radio"/>	<input type="radio"/>

NEW QUESTION 282

A company assigns a Microsoft 365 license to each employee.  
You need to install Microsoft Office 365 ProPlus on each employee device.  
Which three methods can you use? Each correct answer presents a complete solution. NOTE: Each correct selection is worth one point.

- A. Use System Center Configuration Manager (SCCM) to deploy Office 365 ProPlus from a local distribution source.
- B. Use System Center Configuration Manager (SCCM) to deploy Office 365 ProPlus from an Office Windows Installer (MSI) package.
- C. Download the Office 365 ProPlus Windows Installer (MSI) packag
- D. Install Office 365 ProPlus from a local distribution source.
- E. Use the Office Deployment Tool (ODT) to download installation files to a local distribution source.Install Office 365 ProPlus by using the downloaded files.
- F. Enable users to download and install Office 365 ProPlus from the Office 365 portal.

Answer: ADE

Explanation:

https://docs.microsoft.com/en-us/deployoffice/plan-microsoft-365-apps

NEW QUESTION 285

A company deploys Microsoft Azure AD. You enable multi-factor authentication.  
You need to inform users about the multi-factor authentication methods that they can use.  
Which of the following methods is NOT a valid multi-factor authentication method in Microsoft 365?

- A. Receive an automated call on the desk phone that includes a verification code
- B. Insert a small card in to a desktop computer and provide a PIN code when prompted
- C. Receive a call on a mobile phone and select the pound sign (#) when prompted
- D. Receive an SMS text message that includes a verification code

Answer: B

Explanation:

References:  
http://techgenix.com/multifactor-authentication-office-365/

NEW QUESTION 286

A company uses Microsoft 365.  
Employees report that their searches are failing in Microsoft Outlook. You need to determine the reason the searches are failing.  
What are two possible ways to achieve this goal? Each correct answer presents a complete solution. NOTE: Each correct selection is worth one point.

- A. View the mailboxes list in the Exchange admin center.
- B. View the Exchange Online advisories in the Service health dashboard.
- C. View the email activity in the usage reports.
- D. Submit a service request in Support Assistant.

Answer: BD

NEW QUESTION 291

Match each authentication identity to its scenario. To answer, drag the appropriate authentication identity from the column on the left to its scenario on the right  
Each authentication identity may be used once, more than once, or not at all.  
NOTE: Each correct match is worth one point.

Authentication identities

Azure Active Directory identity only

Active Directory identity only

Azure Active Directory identity and Active Directory identity

Answer Area

Scenario

Used to provide authentication for Microsoft 365 services

Used to provide authentication for Exchange Server

Authentication Identity

- A. Mastered
- B. Not Mastered

Answer: A

Explanation:

A picture containing table Description automatically generated

NEW QUESTION 295

Instructions: For each of the following statements, select Yes if the statement is true. Otherwise, select No. NOTE: Each correct selection is worth one point.

Answer Area

Statements

A cloud provider can provide maintenance and security protection for server hardware.

A cloud storage provider can include built-in redundancy and automatic logging.

A cloud provider can manage on-premises resource hardware.

Yes

No

☐

☐

☐

☐

☐

- A. Mastered
- B. Not Mastered

Answer: A

Explanation:

Answer Area

Statements	Yes	No
A cloud provider can provide maintenance and security protection for server hardware.	<input checked="" type="radio"/>	<input type="radio"/>
A cloud storage provider can include built-in redundancy and automatic logging.	<input checked="" type="radio"/>	<input type="radio"/>
A cloud provider can manage on-premises resource hardware.	<input type="radio"/>	<input checked="" type="radio"/>

NEW QUESTION 296

You are the Microsoft 365 administrator for a company. Which Microsoft 365 components should employees use?  
 Match each component to its task. To answer, drag the appropriate components from the column on the left to the tasks on the right. Each component may be used once, more than once, or not at all.  
 NOTE: Each correct match is worth one point.

Components	Task	Components
Windows 10 Enterprise	Send an email to a distribution list.	component
Microsoft Exchange Online	Author a document at the same time as someone else and use document versioning.	component
Microsoft SharePoint Online	Hold a voice and video conversation with other employees.	component
Microsoft Teams	Register a personal device with the company.	component
Microsoft Enterprise Mobility + Security	View a personal calendar.	component

- A. Mastered
- B. Not Mastered

Answer: A

Explanation:

References:  
<https://products.office.com/en-us/microsoft-teams/group-chat-software> <https://www.microsoft.com/en-cy/cloud-platform/enterprise-mobility-security>

NEW QUESTION 301

You are the Microsoft 365 administrator for a company. You identify the following requirements:

Department	Office desktop products required	Requirements
acquisitions	Yes	Users require Office desktop products and must be able to schedule audio conferencing calls.
customer service	No	Users must be able to collaborate with other users and view their work schedules each week.
finance	Yes	You must automate investigation and response to threats against finance department content.
purchasing	Yes	Users require Office desktop products but do not require audio-conferencing capabilities.

You need to purchase Office 365 subscription based on the requirements for each department.  
 Which type of subscription should you use for each department? To answer, drag the appropriate license types to the correct departments. Each license type may be used once, more than once, or not at all. You may need to drag the split bar between panes or scroll to view content.  
 NOTE: Each correct selection is worth one point.



Subscription types

- Microsoft 365 F1
- Microsoft 365 E3
- Microsoft 365 E5

Answer Area

Department	Subscription type
acquisitions	Subscription type
customer service	Subscription type
finance	Subscription type
purchasing	Subscription type

- A. Mastered  
B. Not Mastered

Answer: A

Explanation:

Subscription types

- Microsoft 365 F1
- Microsoft 365 E3
- Microsoft 365 E5

Answer Area

Department	Subscription type
acquisitions	Microsoft 365 E5
customer service	Microsoft 365 F1
finance	Microsoft 365 E5
purchasing	Microsoft 365 E3

NEW QUESTION 302

A company is developing their Windows as a service (WaaS) strategy. The company wants to roll out the most recently released Windows updates to specific devices before rolling them out to other devices. You need to recommend the correct feature to meet the requirement. Which feature should you recommend?

- A. Insider Preview builds  
B. Group policies  
C. Servicing stack updates  
D. Deployment rings  
E. Servicing channels

Answer: D

NEW QUESTION 307

A company plans to deploy automated workflows for managers to approve. You 365 products allow access to personal workflows. Which two products should the managers use? Each correct answer presents a partial solution. NOTE: Each correct selection is worth one point.

- A. Power Automate  
B. Microsoft Excel  
C. Yammer  
D. Microsoft Teams

Answer: AD

Explanation:

Power Automate is the new name for Microsoft Flow.

NEW QUESTION 312

A company plans to use Microsoft 365 Defender. Which services should you use? To answer, drag the appropriate services to the correct requirements. Each service may be used once, more than once, or not at all. You may need to drag the split bar between panes or scroll to view content. NOTE: Each correct selection is worth one point.

Answer Area

Services	Requirement	Service
Microsoft Cloud App Security	Protect against malicious links in email.	
Microsoft Defender for Endpoint	Identify unprotected Windows servers.	
Microsoft Defender for Office 365		

- A. Mastered
- B. Not Mastered

Answer: A

Explanation:  
Graphical user interface, text, application, chat or text message Description automatically generated

NEW QUESTION 316

A company wants to analyze content by using Microsoft 365 Apps. You need to describe the connected experiences the company can use. Which connected experiences should you describe? TO answer, drag the appropriate connected experiences to the correct descriptions. Each connected experience may be used once, more than once. or not at all. You may need to drag the split bar between panes or scroll to view content. NOTE: Each correct selection is worth one point.

Connected experiences

Editor

Tap

Similarity checker

Friendly links

Answer Area

Description	Connected experience
Provides advanced grammar and style refinements such as clarity, conciseness, formality, and vocabulary suggestions.	Connected experience
Allows you to use and repurpose existing content from relevant files most often used by coworkers	Connected experience

- A. Mastered
- B. Not Mastered

Answer: A

Explanation:  
Box 1 = Editor Box 2 = Tap

NEW QUESTION 321

A company uses Microsoft cloud services. The company needs to protect against security breaches. You need to follow Microsoft's approach to security. Which approach should you use?

- A. Will never breach security of specific applications
- B. Will never breach the perimeter network
- C. Will never breach security
- D. Will only breach the perimeter network
- E. Will breach security

Answer: C

Explanation:  
Microsoft's approach to security is to use a defense-in-depth strategy, which involves multiple layers of security controls to protect the company's data, applications, and infrastructure. These layers can include things like user authentication and authorization, firewalls, malware protection, encryption, and more. By implementing these layers of security, the company can greatly reduce the chances of a successful breach.

NEW QUESTION 326

You need to identify which reports provide the information that the company requests. Which reports should you select? To answer, drag the appropriate reports to the correct type of information. Each report may be used once, more than once, or not at all. You may need to drag the split bar between panes or scroll to view content. NOTE: Each correct selection is worth one point.

Reports	Answer Area
Active users	<b>Information</b>  Identifies the number of product licenses assigned to employees.  Identifies the rules applied to information that is classified as sensitive.
Forms Pro activity	
Supervisory review	
Data loss prevention	

- A. Mastered  
 B. Not Mastered

**Answer:** A

**Explanation:**

Graphical user interface, application Description automatically generated

Box 1: Active users

You can use the Active Users report to find out how many product licenses are being used by individuals in your organization, and drill down for information about which users are using what products.

Box 2: Data loss prevention

**NEW QUESTION 329**

DRAG DROP

Match each scenario to its platform or platforms.

Instructions: To answer, drag the appropriate scenario from the column on the left to its platform or platforms on the right. Each scenario may be used only once.

NOTE: Each correct match is worth one point.

Answer Area		
Scenarios	Platform	Scenario
Provide physical access to the hardware.	On-premises only	
Do not require patching of operating systems.	Cloud only	
Monitor usage of the file storage.	Both cloud and on-premises	

- A. Mastered  
 B. Not Mastered

**Answer:** A

**Explanation:**

Answer Area		
Scenarios	Platform	Scenario
Provide physical access to the hardware.	On-premises only	Provide physical access to the hardware.
Do not require patching of operating systems.	Cloud only	Do not require patching of operating systems.
Monitor usage of the file storage.	Both cloud and on-premises	Monitor usage of the file storage.



### NEW QUESTION 333

You are the Microsoft 365 administrator for an organization.

A group of employees and users outside the company must be able to collaborate on a project in real time by using a whiteboard.

In the Microsoft 365 admin portal, which Office 365 product should you configure?

- A. Microsoft Yammer
- B. Microsoft Office Delve
- C. Microsoft SharePoint Online
- D. Microsoft Teams

**Answer: D**

#### Explanation:

References:

<https://docs.microsoft.com/en-us/microsoftteams/manage-whiteboard>

### NEW QUESTION 337

A company plans to deploy Microsoft 365.

Match each collaboration solution to its description. To answer, drag the appropriate collaboration solution from the column on the left to its description on the right.

Each collaboration solution may be used once, more than once, or not at all.

NOTE: Each correct match is worth one point.

Collaboration Solutions	Answer Area	Description	Collaboration Solution
Microsoft Forms		Create online surveys and polls and track the responses in real time.	Microsoft Forms
Microsoft Planner		Create, assign, and track tasks and work items.	Microsoft Planner
Azure AD Premium P2			
Microsoft Delve			

- A. Mastered
- B. Not Mastered

**Answer: A**

#### Explanation:

Collaboration Solutions	Answer Area	Description	Collaboration Solution
Microsoft Forms		Create online surveys and polls and track the responses in real time.	Microsoft Delve
Microsoft Planner		Create, assign, and track tasks and work items.	Microsoft Forms
Azure AD Premium P2			
Microsoft Delve			

### NEW QUESTION 342

Instructions: For each of the following statements, select Yes if the statement is true. Otherwise, select No. NOTE: Each correct selection is worth one point.

Statements	Yes	No
Microsoft Cloud App Security is used to block a specific application in a company.	<input type="radio"/>	<input type="radio"/>
Microsoft Cloud App Security provides offerings that prevent confidential information from leaking outside the organization.	<input type="radio"/>	<input type="radio"/>
Microsoft manages legal requests for a company's data that is in Microsoft Cloud App Security.	<input type="radio"/>	<input type="radio"/>

- A. Mastered
- B. Not Mastered

**Answer: A**

Explanation:  
Answer Area

Statements	Yes	No
Microsoft Cloud App Security is used to block a specific application in a company.	<input checked="" type="radio"/>	<input type="radio"/>
Microsoft Cloud App Security provides offerings that prevent confidential information from leaking outside the organization.	<input checked="" type="radio"/>	<input type="radio"/>
Microsoft manages legal requests for a company's data that is in Microsoft Cloud App Security.	<input type="radio"/>	<input checked="" type="radio"/>

NEW QUESTION 346

A company is migrating to Microsoft 365.  
The company is evaluating app integrations in Microsoft Teams  
Which app integrations should you recommend? To answer, drag the appropriate integrations to the correct features. Each integration may be used once, more than once, or not at all. You may need to drag the split bar between panes or scroll to view content.  
NOTE: Each correct selection is worth one point

Integrations

Outgoing webhooks

Incoming webhooks

Connectors

Cards

Answer Area

Feature	Integration
Allows users to send text-based messages to a company's web services.	
Enables external services to send messages to Teams channels through an HTTP endpoint.	
Allows users to subscribe to receive alerts and information from web services.	

- A. Mastered
- B. Not Mastered

Answer: A

Explanation:

Integrations

Outgoing webhooks

Incoming webhooks

Connectors

Cards

Answer Area

Feature	Integration
Allows users to send text-based messages to a company's web services.	Outgoing webhooks
Enables external services to send messages to Teams channels through an HTTP endpoint.	Incoming webhooks
Allows users to subscribe to receive alerts and information from web services.	Connectors

NEW QUESTION 348

A company that uses Microsoft 365 plans to deploy updates to computers.  
You need to choose the appropriate update channel based on each requirement.  
Which update channel should you use for each requirement? To answer, drag the appropriate update channels to the correct requirements. Each update channel may be used once, more than once, or not at all. You may need to drag the split bar between panes or scroll to view content.  
NOTE: Each correct match is worth one point.

Update channels	Requirement	Update channel
Current	Provides the newest features as soon as they are ready	Update channel
Monthly Enterprise	Provides the newest feature updates on a schedule	Update channel
Semi-Annual Enterprise	Provides the most amount of time to test feature updates	Update channel

- A. Mastered  
 B. Not Mastered

Answer: A

Explanation:

Update channels	Requirement	Update channel
Current	Provides the newest features as soon as they are ready	Current
Monthly Enterprise	Provides the newest feature updates on a schedule	Monthly Enterprise
Semi-Annual Enterprise	Provides the most amount of time to test feature updates	Semi-Annual Enterprise

#### NEW QUESTION 352

Instructions: For each of the following statements, select Yes if the statement is true, Otherwise, select No, NOTE: Each correct selection is worth one point.

Statements	Yes	No
You can use Microsoft Teams and SharePoint Newsfeed to provide enterprise social features in SharePoint.	<input type="radio"/>	<input type="radio"/>
You can disable the enterprise social collaboration feature in SharePoint.	<input type="radio"/>	<input type="radio"/>
You can use different enterprise social collaboration services in SharePoint simultaneously.	<input type="radio"/>	<input type="radio"/>

- A. Mastered  
 B. Not Mastered

Answer: A

Explanation:

Yes, No, Yes

#### NEW QUESTION 356

A company is evaluating Microsoft 365 Apps.

The company needs to track all travel reservations and itineraries for its team members by project in a single file. Each project must have its own tab.

You need to recommend the correct solution for the company. Which solution should you recommend?

- A. Microsoft Publisher  
 B. Microsoft Access  
 C. Microsoft OneNote  
 D. Microsoft OneDrive  
 E. Microsoft Word

Answer: D

#### NEW QUESTION 357

An organization uses Microsoft 365 Business to secure their data.

Many users install the organization's data on their personal tablets and phones. You need to protect the organization's data stored on users' devices.



Which three features support device security? Each correct answer presents a complete solution. NOTE: Each correct selection is worth one point.

- A. Remotely wiping company data
- B. Enabling Advanced Threat Protection for users
- C. Disabling the device remotely
- D. Automatically deleting files after 90 days of inactivity
- E. Requiring users to have a PIN on their device

**Answer:** ADE

**Explanation:**

You can manage many of the Microsoft 365 Business security features in the admin center, which gives you a simplified way to turn these features on or off. In the admin center, you can do the following:

Set application management settings for Android or iOS devices.

These settings include deleting files from an inactive device after a set period, encrypting work files, requiring that users set a PIN, and so on.

Set application protection settings for Windows 10 devices.

These settings can be applied to company data on both company-owned, or personally owned devices.

Set device protection settings for Windows 10 devices.

You can enable BitLocker encryption to help protect data in case a device is lost or stolen, and enable Windows Exploit Guard to provide advanced protection against ransomware.

Remove company data from devices.

You can remotely wipe company data if a device is lost, stolen, or an employee leaves your company. Reset Windows 10 devices to their factory settings.

You can reset any Windows 10 devices that have device protection settings applied to them. References:

<https://docs.microsoft.com/en-us/microsoft-365/business/security-features>

**NEW QUESTION 359**

A company uses Microsoft 365.

The company wants to create a chat bot for integration with Microsoft Teams. You need to identify a solution to create the chat bot.

Which solution should you choose?

- A. Remote Assist
- B. Dynamics 365 Customer Service
- C. Power Virtual Agent
- D. Dynamics 365 Guides

**Answer:** C

**NEW QUESTION 362**

This question requires that you evaluate the bold text to determine if it is correct.

A company needs to protect documents and emails by automatically applying classifications and labels. You must minimize costs. You should implement Microsoft Azure Information Protection for Microsoft Office 365.

Review the underlined text. If it makes the statement correct select No change is needed. If the statement is incorrect, select the answer choice that makes the statement correct.

- A. No change needed.
- B. Azure Information Protection Premium P2
- C. Azure Information Protection Premium PI
- D. Microsoft 365 E3

**Answer:** B

**Explanation:**

References:

<https://products.office.com/en-za/business/azure-information-protection-for-office-365>

**NEW QUESTION 366**

You need to ensure that the process by which users sign in to Microsoft 365 confirms the identity of the user. Which feature should you use?

- A. mobile application management (MAM)
- B. Advanced Threat Protection (ATP)
- C. Multi-Factor Authentication (MFA)
- D. data loss prevention (DLP) policies

**Answer:** C

**Explanation:**

Multi-Factor Authentication (MFA) is a two-step identity verification system that can be used to authenticate users.

**NEW QUESTION 371**

A company plans to deploy a solution to manage its Windows 10 computers. Some computers are connected to the corporate network and some computers are connected to the internet,

The solution must meet the following requirements:

- Deploy an operating system to the computers.
- Join the computer to an on-premises Active Directory domain.
- Install Windows updates to the computers.

You need to identify a solution that meets the requirements. Which solution should you choose?

- A. Microsoft Endpoint Manager

- B. Microsoft Intune
- C. Windows Autopilot
- D. Configuration Manager

Answer: A

Explanation:

Endpoint Manager includes the services and tools you use to manage and monitor mobile devices, desktop computers, virtual machines, embedded devices, and servers. Endpoint Manager combines services, including Microsoft Intune, Configuration Manager, Desktop Analytics, co-management, and Windows Autopilot.

NEW QUESTION 373

You are a Microsoft 365 administrator for a company. The company implements federated authentication and Azure AD Connect. For each of the following statements, select Yes if the statement is true. Otherwise, select No.  
NOTE: Each correct selection is worth one point.

Statement	Yes	No
Users have the same passwords in the cloud and on-premises.	<input type="radio"/>	<input type="radio"/>
Users sing in again to access Microsoft 365.	<input type="radio"/>	<input type="radio"/>
You can configure federated authentication to require a smart card.	<input type="radio"/>	<input type="radio"/>

- A. Mastered
- B. Not Mastered

Answer: A

Explanation:

References:  
<https://docs.microsoft.com/en-us/azure/security/fundamentals/choose-ad-authn>

NEW QUESTION 377

A company plans to deploy Azure Active Directory (Azure AD). The company needs to purchase the appropriate Azure AD license or licenses while minimizing the cost. Match each Azure AD license to its requirement. To answer, drag the appropriate Azure AD license from the column on the left to its requirement on the right. Each Azure AD license may be used once, more than once, or not at all.  
NOTE: Each correct match is worth one point.

Licenses	Answer Area	
	Requirement	License
Azure AD Free	Provides self-service password change for cloud users	<input type="text"/>
Azure AD Premium P1	Provides self-service group management for on-premises and cloud users	<input type="text"/>
Azure AD Premium P2	Provides multi-factor authentication for cloud users	<input type="text"/>

- A. Mastered
- B. Not Mastered

Answer: A

Explanation:

## Licenses

- Azure AD Free
- Azure AD Premium P1
- Azure AD Premium P2

## Answer Area

### Requirement

- Provides self-service password change for cloud users
- Provides self-service group management for on-premises and cloud users
- Provides multi-factor authentication for cloud users

### License

- Azure AD Free
- Azure AD Premium P1
- Azure AD Free

## NEW QUESTION 382

A company is evaluating ways to improve their productivity by using Microsoft 365. You need to determine the correct productivity feature. Select the answer that correctly completes the sentence.

A company can view a team's work patterns, such as regular after-hours work, by using

- Manager insights
- Personal insights
- Application insights
- Leader insights
- Customer insights

- A. Mastered
- B. Not Mastered

**Answer:** A

### Explanation:

Leader Insight

## NEW QUESTION 383

This question requires that you evaluate the bold text to determine if it is correct.

You use Microsoft Intune for device management. You must determine how many devices run each operating system.

You must launch Intune and navigate to the Mobile Apps blade.

Select the correct answer if the underlined text does not make the statement correct. Select "No change is needed" if the underlined text makes the statement correct.

- A. Device configuration
- B. Device compliance
- C. No change is needed
- D. Devices

**Answer:** D

### Explanation:

References:

<https://docs.microsoft.com/en-us/intune/device-inventory>

## NEW QUESTION 387

A company is evaluating the services provided in Microsoft 365. You need to ensure the service meets the following requirements:

- Allows users to upload corporate videos to a centralized location
- Allows users to watch trending and most popular corporate videos.

You need to recommend a Microsoft 365 service that meets the requirements. Which service should you use?

- A. Microsoft Teams
- B. Microsoft Stream
- C. MicrosoftOneDrive
- D. SharePoint Online

**Answer:** B

## NEW QUESTION 389

A company uses Microsoft 365.

You need to identify the portal that users should use to install Office applications. What should you identify?

- A. Azure portal
- B. Microsoft 365 user portal
- C. Microsoft 365 admin center
- D. Microsoft Volume Licensing Service Center



Answer: C

NEW QUESTION 392

You are planning a Microsoft Azure AD solution for a company.  
For each of the following statements, select Yes if the statement is true. Otherwise, select No. NOTE: Each correct selection is worth one point.

Statement	Yes	No
You can manage Azure AD-joined machines by using group policy.	<input type="radio"/>	<input type="radio"/>
Azure AD requires integration with Active Directory Domain Services by using secure lightweight Directory Access Protocol (LDAP).	<input type="radio"/>	<input type="radio"/>
Azure AD supports Azure AD Authentication Library (ADAL) authentication.	<input type="radio"/>	<input type="radio"/>

- A. Mastered
- B. Not Mastered

Answer: A

Explanation:

Yes – <https://docs.microsoft.com/en-us/azure/active-directory-domain-services/manage-group-policy> Settings for user and computer objects in Azure Active Directory Domain Services (Azure AD DS) are often managed using Group Policy Objects (GPOs).  
Yes – <https://docs.microsoft.com/en-us/azure/active-directory-domain-services/tutorial-configure-ldaps> To communicate with your Azure Active Directory Domain Services (Azure AD DS) managed domain, the Lightweight Directory Access Protocol (LDAP) is used. By default, the LDAP traffic isn't encrypted, which is a security concern for many environments.  
Yes  
– <https://docs.microsoft.com/en-us/azure/active-directory/azuread-dev/active-directory-authentication-libraries> Azure Active Directory Authentication Library (ADAL) v1.0 enables application developers to authenticate users to cloud or on-premises Active Directory (AD), and obtain tokens for securing API calls.

NEW QUESTION 393

Instructions: For each of the following statements, select Yes if the statement is true. Otherwise, select No. NOTE: Each correct selection is worth one point.

Statements	Yes	No
Data loss prevention (DLP) policies allow you to search for content in Microsoft Teams and SharePoint Online and export the content for review.	<input type="radio"/>	<input type="radio"/>
Sensitivity labels allow you to refine the results from a search for content in Microsoft Teams and SharePoint Online.	<input type="radio"/>	<input type="radio"/>
Advanced eDiscovery allows you to manage the custodians that are relevant to a case.	<input type="radio"/>	<input type="radio"/>

- A. Mastered
- B. Not Mastered

Answer: A

Explanation:

Statements	Yes	No
Data loss prevention (DLP) policies allow you to search for content in Microsoft Teams and SharePoint Online and export the content for review.	<input checked="" type="radio"/>	<input type="radio"/>
Sensitivity labels allow you to refine the results from a search for content in Microsoft Teams and SharePoint Online.	<input type="radio"/>	<input checked="" type="radio"/>
Advanced eDiscovery allows you to manage the custodians that are relevant to a case.	<input checked="" type="radio"/>	<input type="radio"/>

NEW QUESTION 396

A company is evaluating Microsoft Dynamics 365.

Instructions: For each of the following statements, select Yes if the statement is true. Otherwise, select No.  
NOTE: Each correct selection is worth one point.

Statements	Yes	No
Microsoft Dynamics 365 provides a remote assistance solution.	<input type="radio"/>	<input type="radio"/>
Microsoft Dynamics 365 provides a customer relationship management solution.	<input type="radio"/>	<input type="radio"/>
Microsoft Dynamics 365 provides an endpoint protection security solution.	<input type="radio"/>	<input type="radio"/>

- A. Mastered
- B. Not Mastered

Answer: A

Explanation:  
Graphical user interface, text, application, email Description automatically generated

NEW QUESTION 399  
A company uses Microsoft 365.  
The company must identify which cloud apps and services are used in the company You need to identify which service can be used to find this information.  
Which service should you use?

- A. Azure Active Directory
- B. Microsoft Cloud App Security
- C. Azure Security Center
- D. Microsoft Defender for Office 365

Answer: B

NEW QUESTION 400  
Your company uses Microsoft Teams.  
Instructions: For each of the following statements, select Yes if the statement is true Otherwise, select No NOTE: Each correct selection is worth one point.

Statements	Yes	No
You can translate a message into another language in Teams.	<input type="radio"/>	<input type="radio"/>
You can use #mentions to notify another user in a channel conversation or in a Teams chat.	<input type="radio"/>	<input type="radio"/>
You can mark a message as important or urgent in Teams.	<input type="radio"/>	<input type="radio"/>

- A. Mastered
- B. Not Mastered

Answer: A

Explanation:

Statements	Yes	No
You can translate a message into another language in Teams.	<input checked="" type="radio"/>	<input type="radio"/>
You can use #mentions to notify another user in a channel conversation or in a Teams chat.	<input checked="" type="radio"/>	<input type="radio"/>
You can mark a message as important or urgent in Teams.	<input checked="" type="radio"/>	<input type="radio"/>

NEW QUESTION 405  
For each of the following statements, select Yes if the statement is true. Otherwise, select No. NOTE: Each correct selection is worth one point.

Statement	Yes	No
A sensitivity level can be used to prevent data loss from Windows devices by turning on the endpoint protection in Microsoft Intune.	<input type="radio"/>	<input type="radio"/>
You can use a sensitivity label to mark the content of documents by adding a custom watermark.	<input type="radio"/>	<input type="radio"/>
After a sensitivity level is applied, the content of documents is encrypted, but the content of email is not encrypted.	<input type="radio"/>	<input type="radio"/>

- A. Mastered
- B. Not Mastered

**Answer:** A

**Explanation:**

References:

<https://docs.microsoft.com/en-us/office365/securitycompliance/sensitivity-labels>

**NEW QUESTION 409**

A company needs to protect users from malicious URLs and attachments that are in emails. You need to select a solution that meets the requirement. Which service should you select?

- A. Microsoft Cloud App Security
- B. Microsoft Defender for Identity
- C. Microsoft Defender for Office 365
- D. Microsoft Defender for Endpoint

**Answer:** C

**NEW QUESTION 413**

You are the Microsoft 365 administrator for a company.

You install Microsoft Office 365 ProPlus on five devices. You deactivate device. Which task can you perform on the deactivated device?

- A. Print a document.
- B. Leave a comment in a document.
- C. Start a new document from a template.
- D. Set properties on a document.
- E. Create a document
- F. Edit a document
- G. Co-author a document

**Answer:** A

**Explanation:**

References:

[https://blogs.technet.microsoft.com/office\\_resource\\_kit/2014/01/17/office-365-proplus-multiple-devices-and-de](https://blogs.technet.microsoft.com/office_resource_kit/2014/01/17/office-365-proplus-multiple-devices-and-de)

When you deactivate a Microsoft Office 365 ProPlus license, Office 365 ProPlus remains installed on the computer, but you can only view and print documents. All features for editing or creating new documents are disabled.

Note:

There are several versions of this question in the exam. The question has two possible correct answers:

- View a document
- Print a document

Other incorrect answer options you may see on the exam include the following:

- Leave a comment in a document.
- Start a new document from a template.
- Set properties on a document.
- Create a document
- Edit a document
- Co-author a document
- Edit a column

**NEW QUESTION 416**

A company uses Microsoft 365.

The company wants users to be prompted for additional verification when they access a federated third-party application. However, users must not be prompted for additional verification when they access Microsoft Outlook.

You need to identify a solution that meets the requirements. Which solution should you choose?

- A. Conditional Access



- B. Multi-factor authentication (MFA)
- C. Active Directory Federation Services (AD FS)
- D. Self-service password reset (SSPR)

Answer: B

NEW QUESTION 420

Instructions: For each of the following statements, select Yes if the statement is true. Otherwise, select No. NOTE: Each correct selection is worth one point.

Answer Area

	Yes	No
You can use sensitivity labels to encrypt emails and documents.	<input type="radio"/>	<input type="radio"/>
You can use sensitivity labels to control read and write access to a Word document as well as permission levels to modify the contents.	<input type="radio"/>	<input type="radio"/>
Sensitivity labels can apply watermarks within a Word document to indicate that the document is for internal company use only.	<input type="radio"/>	<input type="radio"/>

- A. Mastered
- B. Not Mastered

Answer: A

Explanation:  
Answer Area

	Yes	No
You can use sensitivity labels to encrypt emails and documents.	<input checked="" type="radio"/>	<input type="radio"/>
You can use sensitivity labels to control read and write access to a Word document as well as permission levels to modify the contents.	<input checked="" type="radio"/>	<input type="radio"/>
Sensitivity labels can apply watermarks within a Word document to indicate that the document is for internal company use only.	<input checked="" type="radio"/>	<input type="radio"/>

NEW QUESTION 424

A company has 250 employees.  
You need to migrate all users to Microsoft 365 and meet the following requirements:

- > Provide a user-centric licensing solution for all users.
- > Manage devices from a single location.
- > Minimize licensing costs.

Which licensing model should you use?

- A. Microsoft 365 Business
- B. Microsoft 365 Education
- C. Microsoft 365 Enterprise E3
- D. Microsoft 365 Enterprise E5

Answer: A

Explanation:  
References:  
<https://products.office.com/en-za/compare-all-microsoft-office-products?tab=2> <https://docs.microsoft.com/en-us/microsoft-365/business/support/microsoft-365-business-faqs>

NEW QUESTION 428

An organization is moving to Microsoft Azure and Microsoft 365. You need to classify the following components:

- > website hosting
- > a virtual machine that runs Linux
- > document storage that uses OneDrive for Business

Match each component to its classification. To answer, drag the appropriate components from the column on the left to its classifications on the right. Each component may be used once, more than once, or not at all.  
NOTE: Each correct selection is worth one point.

Classifications	Component	Classification
Platform as a service (PaaS)	website hosting	
Software as a service (SaaS)	a virtual machine that runs Linux	
Infrastructure as a service (IaaS)	document storage that uses OneDrive for Business	

- A. Mastered
- B. Not Mastered

Answer: A

Explanation:

Classifications	Component	Classification
Platform as a service (PaaS)	website hosting	Platform as a service (PaaS)
Software as a service (SaaS)	a virtual machine that runs Linux	Infrastructure as a service (IaaS)
Infrastructure as a service (IaaS)	document storage that uses OneDrive for Business	Software as a service (SaaS)

NEW QUESTION 430

A company is evaluating threat protection in Microsoft 365.  
instructions: For each of the following statements, select Yes if the statement is true Otherwise, select No. NOTE: Each correct selection is worth one point.

Statements	Yes	No
Microsoft 365 Defender for Endpoint can block malware on Windows 10 devices.	<input type="radio"/>	<input type="radio"/>
Microsoft 365 Defender for Office 365 is a solution that can detect malicious emails.	<input type="radio"/>	<input type="radio"/>
Microsoft 365 Defender for Endpoint requires a separate installation for Windows 10 devices.	<input type="radio"/>	<input type="radio"/>

- A. Mastered
- B. Not Mastered

Answer: A

Explanation:

Statements	Yes	No
Microsoft 365 Defender for Endpoint can block malware on Windows 10 devices.	<input checked="" type="radio"/>	<input type="radio"/>
Microsoft 365 Defender for Office 365 is a solution that can detect malicious emails.	<input checked="" type="radio"/>	<input type="radio"/>
Microsoft 365 Defender for Endpoint requires a separate installation for Windows 10 devices.	<input checked="" type="radio"/>	<input type="radio"/>

NEW QUESTION 433

A company is evaluating Microsoft 365.  
You need to recommend a service that meets the company s requirements.  
A company can improve employee engagement by allowing employees to create user posts and share files within an interest group by using Microsoft \_\_\_\_\_

- A. Mastered
- B. Not Mastered

Answer: A

Explanation:

Yammer

NEW QUESTION 434

A company has a Microsoft 365 subscription. Employees use personal devices to access company data in the cloud.  
You need to restrict employees from copying data to personal OneDrive folders. What should you use?

- A. Information Rights Management
- B. Microsoft Azure Security Center

- C. Office 365 Advanced Threat Protection
- D. Intune App Protection

Answer: D

Explanation:

References:

<https://docs.microsoft.com/en-us/intune/app-protection-policy>

NEW QUESTION 438

A company is moving to Microsoft Azure. Some applications cannot be moved.

You need to identify which application will remain in a hybrid environment after the migration. Which applications will remain in a hybrid environment?

- A. applications that manage sensitive information
- B. applications that use a USB token device to control access
- C. legacy applications that use a message based interlace
- D. a new server that runs several line-of business applications

Answer: A

NEW QUESTION 442

HOTSPOT

For each of the following statements, select Yes if the statement is true. Otherwise, select No. NOTE: Each correct selection is worth one point.

Statement	Yes	No
Cloud computing delivers software on demand.	<input type="radio"/>	<input type="radio"/>
Cloud computing provides backup and recovery.	<input type="radio"/>	<input type="radio"/>
Cloud computing enables low-cost infrastructure scaling.	<input type="radio"/>	<input type="radio"/>

- A. Mastered
- B. Not Mastered

Answer: A

Explanation:

Statement	Yes	No
Cloud computing delivers software on demand.	<input checked="" type="radio"/>	<input type="radio"/>
Cloud computing provides backup and recovery.	<input checked="" type="radio"/>	<input type="radio"/>
Cloud computing enables low-cost infrastructure scaling.	<input checked="" type="radio"/>	<input type="radio"/>

NEW QUESTION 444

You add a comment to a Word document that includes the @ sign and a user's name.

Instructions: For each of the following statements, select Yes if the statement is true. Otherwise, select No.

NOTE: Each correct selection is worth one point.



Statements	Yes	No
The email notification that the user receives displays a preview of the document text and the associated comment.	<input type="radio"/>	<input type="radio"/>
When the user clicks the link in the email, the document opens to the comment in the file.	<input type="radio"/>	<input type="radio"/>
The user can respond to the comment in the document directly from the email.	<input type="radio"/>	<input type="radio"/>

- A. Mastered  
B. Not Mastered

Answer: A

Explanation:

Graphical user interface, text, application, email Description automatically generated

NEW QUESTION 445

A company is evaluating Microsoft 365.  
You need to recommend a service that meets the company's requirements. Select the answer that correctly completes the sentence.

Answer Area

A company can improve employee engagement by allowing employees to create user posts and share files within an interest group by using Microsoft

- A. Mastered  
B. Not Mastered

Answer: A

Explanation:

Answer Area

A company can improve employee engagement by allowing employees to create user posts and share files within an interest group by using Microsoft

NEW QUESTION 447

Match each tool to its definition.  
Instructions: To answer, drag the appropriate tool from the column on the left to its definition on the right. Each tool may be used once, more than once, or not at all.  
NOTE: Each correct selection is worth one point.

Tools	Requirement	Tool
Azure Active Directory Identity Protection	Use artificial intelligence to detect anomalies and suspicious incidents.	<input type="text" value="Tool"/>
Azure Advanced Threat Protection	Identify and detect malicious insider actions to make it more difficult to compromise user credentials.	<input type="text" value="Tool"/>
Microsoft Exchange Online Protection	Protect against spam and help prevent messaging policy violations.	<input type="text" value="Tool"/>
Office 365 Threat Intelligence	Scan emails and URLs to identify impersonation and malicious files.	<input type="text" value="Tool"/>

- A. Mastered  
B. Not Mastered

Answer: A

Explanation:

Tools

- Azure Active Directory Identity Protection
- Azure Advanced Threat Protection
- Microsoft Exchange Online Protection
- Office 365 Threat Intelligence

Answer Area

Requirement	Tool
Use artificial intelligence to detect anomalies and suspicious incidents.	Azure Active Directory Identity Protection
Identify and detect malicious insider actions to make it more difficult to compromise user credentials.	Azure Advanced Threat Protection
Protect against spam and help prevent messaging policy violations.	Microsoft Exchange Online Protection
Scan emails and URLs to identify impersonation and malicious files.	Office 365 Threat Intelligence

NEW QUESTION 449

.....

## THANKS FOR TRYING THE DEMO OF OUR PRODUCT

Visit Our Site to Purchase the Full Set of Actual MS-900 Exam Questions With Answers.

We Also Provide Practice Exam Software That Simulates Real Exam Environment And Has Many Self-Assessment Features. Order the MS-900 Product From:

<https://www.2passeasy.com/dumps/MS-900/>

## Money Back Guarantee

### MS-900 Practice Exam Features:

- \* MS-900 Questions and Answers Updated Frequently
- \* MS-900 Practice Questions Verified by Expert Senior Certified Staff
- \* MS-900 Most Realistic Questions that Guarantee you a Pass on Your FirstTry
- \* MS-900 Practice Test Questions in Multiple Choice Formats and Updatesfor 1 Year