



**Microsoft**

## **Exam Questions MS-600**

Building Applications and Solutions with Microsoft 365 Core Services

### NEW QUESTION 1

- (Exam Topic 1)

Which URI should you use to query all the emails that relate to an invoice?

```
https://graph.microsoft.com/v1.0/me/messages?$search="{invoiceid}"

https://graph.microsoft.com/v1.0/me/messages?$subject eq {invoiceid}

https://graph.microsoft.com/v1.0/me/messages?${invoiceid}

https://graph.microsoft.com/v1.0/me/messages?$filter=contains(subject,{invoiceid})
```

- A. Option A
- B. Option B
- C. Option C
- D. Option D

**Answer:** A

### NEW QUESTION 2

- (Exam Topic 1)

You need to complete the MSAL.js code for SSO. Which code segment should you insert at line 06?

- A. storeAuthStateInCookie: false
- B. storeAuthStateInCookie: true
- C. cacheLocation: 'localStorage'
- D. cacheLocation: 'sessionStorage'

**Answer:** C

#### Explanation:

Scenario: Implement single sign-on (SSO) and minimize login prompts across browser tabs.

When your application is open in multiple tabs and you first sign in the user on one tab, the user is also signed in on the other tabs without being prompted.

MSAL.js caches the ID token for the user in the browser localStorage and will sign the user in to the application on the other open tabs.

By default, MSAL.js uses sessionStorage which does not allow the session to be shared between tabs. To get SSO between tabs, make sure to set the cacheLocation in MSAL.js to localStorage.

Reference: <https://docs.microsoft.com/bs-latn-ba/Azure/active-directory/develop/msal-js-sso>

### NEW QUESTION 3

- (Exam Topic 1)

How can you validate that the JSON notification message is sent from the Microsoft Graph service?

- A. The ClientState must match the value provided when subscribing.
- B. The user\_guid must map to a user ID in the Azure AD tenant of the customer.
- C. The tenant ID must match the tenant ID of the customer's Office 365 tenant.
- D. The subscription ID must match the Azure subscription used by ADatum.

**Answer:** A

#### Explanation:

clientState specifies the value of the clientState property sent by the service in each notification. The maximum length is 128 characters. The client can check that the notification came from the service by comparing the value of the clientState property sent with the subscription with the value of the clientState property received with each notification.

Note: A subscription allows a client app to receive notifications about changes to data in Microsoft Graph. Reference: <https://docs.microsoft.com/en-us/graph/api/resources/subscription>

### NEW QUESTION 4

- (Exam Topic 1)

You need to protect the backend web service to meet the technical requirements.

Which four actions should you perform in sequence? To answer, move the actions from the list of actions to the answer area and arrange them in the correct order.

## Actions

Set the App ID URI for the backend web service application registration

Register an application in Azure AD for the backend web service

Define the scopes in the E-invoicing application registration

Register an application in Azure AD for E-invoicing. Grant admin consent to the E-invoicing application registration to the API scopes of the backend web service application registration

Define the scopes in the backend web service application registration

## Answer Area



- A. Mastered
- B. Not Mastered

**Answer:** A

### Explanation:

Here is a quick overview of the steps:

Step 1: Register an application in Azure AD for the backend web service Register an application (backend-app) in Azure AD to represent the API. Step 2: Set the App ID URI for the backend service application registration

When the application is created (step 1) select Expose an API and click on Save and continue to create an Application ID URI.

Step 3: Defend the scopes in the backend web service application registration

In the Add a scope page, create a new scope supported by the API. (e.g., Read) then click on Add scope to create the scope. Repeat this step to add all scopes supported by your API.

Step 4: Register an application in Azure AD for E-invoicing.

Step 4.1 Register another application in Azure AD to represent a client application

Step 4.2 Now that you have registered two applications to represent the API and the Developer Console, you need to grant permissions to allow the client-app to call the backend-app.

Scenario:

Secure access to the backend web service by using Azure AD

E- invoicing will have internal logic that will dynamically identify whether the user should be allowed to call the backend API.

Reference:

<https://docs.microsoft.com/en-us/azure/api-management/api-management-howto-protect-backend-with-aad>

### NEW QUESTION 5

- (Exam Topic 2)

You need to develop an add-in for Microsoft Excel that can be used from the Windows, Mac, and web versions of Excel.

What are two ways to develop the add-in? Each correct answer presents a complete solution?

NOTE: Each correct selection is worth one point.

- A. From Microsoft Teams, install App Studio
- B. From Microsoft Visual Studio that has the Microsoft Office/SharePoint development workload installed, create a new project that uses a Web Add-in template
- C. From the Microsoft Office 365 portal, use Microsoft PowerApps
- D. Use the Yeoman generator for Microsoft Office Add-ins to create the project, and then open the project in Microsoft Visual Studio Code
- E. From Microsoft Visual Studio that has the Microsoft Office/SharePoint development workload installed, create a new project that uses a Visual Studio Tools for Office (VSTO) template

**Answer:** DE

### Explanation:

D: Run the following command to create an add-in project using the Yeoman generator: yo office

Visual Studio Code is a great tool to help you develop your custom Office Add-ins regardless if they are for Outlook, Word, Excel, PowerPoint and run in the web clients, Windows clients, iOS clients or on macOS.

Open the project in Visual Studio Code by entering the following on the command line from within the same folder where you ran the generator: code.

E: You can create VSTO Add-ins for Excel.

To create a new Excel VSTO Add-in project in Visual Studio

- > Start Visual Studio.
- > On the File menu, point to New, and then click Project.
- > In the templates pane, expand Visual C# or Visual Basic, and then expand Office/SharePoint.
- > Under the expanded Office/SharePoint node, select the Office Add-ins node.
- > In the list of project templates, select Excel 2010 Add-in or Excel 2013 Add-in.
- >

In the Name box, type FirstExcelAddIn.

➤ Click OK.

Visual Studio creates the FirstExcelAddIn project and opens the ThisAddIn code file in the editor. References: <https://docs.microsoft.com/en-us/office/dev/add-ins/tutorials/excel-tutorial> [https://code.visualstudio.com/docs/other/office#\\_use-visual-studio-code-to-develop-your-office-addin](https://code.visualstudio.com/docs/other/office#_use-visual-studio-code-to-develop-your-office-addin) <https://docs.microsoft.com/en-us/visualstudio/vsto/walkthrough-creating-your-first-vsto-add-in-for-excel>

#### NEW QUESTION 6

- (Exam Topic 2)

You are developing a server-based web app that will use OAuth2 on behalf of the user and will be registered with the Microsoft identity platform.

Which two types of token will the app retrieve as part of the authorization flow? Each correct answer presents part of the solution. NOTE: Each correct selection is worth one point.

- A. context token
- B. Kerberos token
- C. refresh token
- D. SAML token
- E. access token

**Answer:** BD

#### NEW QUESTION 7

- (Exam Topic 2)

This question requires that you evaluate the underlined BOLD text to determine if it is correct.

You develop a Microsoft Teams application that uses a messaging extension. Users can invoke the messaging extension from the Teams sidebar menu.

Instructions: Review the underlined text. If it makes the statement correct, select “No change is needed”. If the statement is incorrect, select the answer choice that makes the statement correct.

- A. No change is needed
- B. from the compose box of a Teams chat
- C. by using the Manage teams option for a team
- D. by using the Add a tab option in the Teams channel

**Answer:** B

#### Explanation:

In the app manifest for your Microsoft Teams app you'll define a single messaging extension with up to ten different commands. Each command defines a type (action or search), and the locations in the client it can be invoked from (compose message area, command bar, and/or message).

Reference:

<https://docs.microsoft.com/en-us/microsoftteams/platform/messaging-extensions/what-are-messaging-extension>

#### NEW QUESTION 8

- (Exam Topic 2)

You need to request permission to create a group in a Sharepoint Framework (SPFx) solution. To which file should you add the permission request?

- A. Config.json
- B. Package.json
- C. Serve.json
- D. Package-solution.json

**Answer:** D

#### NEW QUESTION 9

- (Exam Topic 2)

You are building a single-page application (SPA) that will have the following parameters:

- App Id: DBA22F72-64PA4C44-AA2C-FAA0DA5A471B
- Tenant Id: DC045C4D-5881-43C7-97AB-3C5A1ADB8DBC
- AppName: Contoso.Spa

You have a line-of-business API for invoicing that is secured by using the Microsoft identity platform. The API has the following parameters:

- \* App Id: 8/9A43D7-1794-47A0-AB2B-440B63FEC248
- \* Tenant Id: DC04SC4D S881-43C7-97AB 3C5A1ADB8DBC
- \* AppName: Contoso.Invoicing

Contoso.Invoicing declares the following custom scopes:

- \* Invoices-Read
- \* Invoices. Read Write

Contoso.Spa needs to call Contoso.Invoicing to create new invoices.

Which code should you use in Contoso.Spa to obtain an access token for Contoso.Invoicing? To answer, select the appropriate options in the answer area.

NOTE: Each correct select is worth one point.



## Answer Area

```
const app = new UserAgentApplication({
  auth: {
    clientId: 'DBA22F72-642A-4C44-AA2C-FAA0DA5A471B',
    clientId: '879A43D7-1794-47A0-AB2B-440B63FEC248',
    clientId: 'DC045C4D-5881-43C7-97AB-3C5A1ADB8DBC',
    authority: 'https://login.microsoftonline.com/DBA22F72-642A-4C44-AA2C-FAA0DA5A471B/',
    authority: 'https://login.microsoftonline.com/879A43D7-1794-47A0-AB2B-440B63FEC248/',
    authority: 'https://login.microsoftonline.com/DC045C4D-5881-43C7-97AB-3C5A1ADB8DBC/',
  },
  system: {
    logger: new Logger(this.logger)
  },
  cache: {cacheLocation: "localStorage"}
});

const response = await app.acquireTokenSilent({
  scopes: ['api://879A43D7-1794-47A0-AB2B-440B63FEC248/Invoices.Read'],
  scopes: ['api://879A43D7-1794-47A0-AB2B-440B63FEC248/Invoices.ReadWrite'],
  scopes: ['api://DBA22F72-642A-4C44-AA2C-FAA0DA5A471B/Invoices.ReadWrite'],
  scopes: ['api://DC045C4D-5881-43C7-97AB-3C5A1ADB8DBC/Invoices.Read'],
  scopes: ['Invoices.Read'],
  scopes: ['Invoices.ReadWrite']
});
```

- A. Mastered  
 B. Not Mastered

Answer: A

Explanation:

## Answer Area

```
const app = new UserAgentApplication({
  auth: {
    clientId: 'DBA22F72-642A-4C44-AA2C-FAA0DA5A471B',
    clientId: '879A43D7-1794-47A0-AB2B-440B63FEC248',
    clientId: 'DC045C4D-5881-43C7-97AB-3C5A1ADB8DBC',
    authority: 'https://login.microsoftonline.com/DBA22F72-642A-4C44-AA2C-FAA0DA5A471B/',
    authority: 'https://login.microsoftonline.com/879A43D7-1794-47A0-AB2B-440B63FEC248/',
    authority: 'https://login.microsoftonline.com/DC045C4D-5881-43C7-97AB-3C5A1ADB8DBC/',
  },
  system: {
    logger: new Logger(this.logger)
  },
  cache: {cacheLocation: "localStorage"}
});

const response = await app.acquireTokenSilent({
  scopes: ['api://879A43D7-1794-47A0-AB2B-440B63FEC248/Invoices.Read'],
  scopes: ['api://879A43D7-1794-47A0-AB2B-440B63FEC248/Invoices.ReadWrite'],
  scopes: ['api://DBA22F72-642A-4C44-AA2C-FAA0DA5A471B/Invoices.ReadWrite'],
  scopes: ['api://DC045C4D-5881-43C7-97AB-3C5A1ADB8DBC/Invoices.Read'],
  scopes: ['Invoices.Read'],
  scopes: ['Invoices.ReadWrite']
});
```

## NEW QUESTION 10

- (Exam Topic 2)

You have an API that is secured by using Azure Active Directory (Azure AD). You are designing a SharePoint Framework (SPFx) solution. Which object should you use to connect to the API from the solution?

- A. SPHttpClient  
 B. HttpClient  
 C. AadHttpClient

Answer: C

Explanation:

By using the AadHttpClient, you can easily connect to APIs secured by using Azure AD without having to implement the OAuth flow yourself.  
Reference: <https://docs.microsoft.com/en-us/sharepoint/dev/spfx/use-aadhttpclient>

NEW QUESTION 10

- (Exam Topic 2)

You have an application that has the code shown in the exhibits. (Click the JavaScript Version tab or the C# Version tab.)  
For each of the following statements, select Yes if the statement is true. Otherwise, select No. NOTE: Each correct selection is worth one point.  
JavaScript Version

```
const fs = require("fs");
const execute = async (accessToken: string, filename: string): Promise<void> => {
    //...
    const stream = await client.api(`/me/drive/root/children/${filename}/content`)
        .getStream();
    let writeStream = fs.createWriteStream(`../${filename}`);
    stream.pipe(writeStream).on("error", (err) => {
        throw err;
    });
    writeStream.on("error", (err) => {
        throw err;
    });
    await new Promise((resolve) => writeStream.on("finish", resolve));
}
//...
```

C# Version

```
namespace MyProject {
    class Handler {
        public async Task Execute(string accessToken, string path) {
            var client = new GraphServiceClient(new GraphAuthProvider(accessToken));
            var pathRequestBuilder = client.Drive.Root.ItemWithPath(path);
            var file = await pathRequestBuilder.Request().GetAsync();
            if (file.File != null)
            {
                using (var content = await pathRequestBuilder.Content.Request().GetAsync())
                using (var diskFile = System.IO.File.Create(file.Name))
                {
                    content.Seek(0, System.IO.SeekOrigin.Begin);
                    await content.CopyToAsync(diskFile);
                    await diskFile.FlushAsync();
                }
            }
        }
    }
}
```

Statements	Yes	No
The code uploads a file to a Microsoft SharePoint Online site.	<input type="radio"/>	<input type="radio"/>
The code creates a file in Microsoft OneDrive.	<input type="radio"/>	<input type="radio"/>
The code downloads a file from Microsoft OneDrive.	<input type="radio"/>	<input type="radio"/>

- A. Mastered
- B. Not Mastered

Answer: A

Explanation:

Box 1: No  
Box 2: No  
Box 3: Yes  
A file is downloaded from OneDrive and saved locally.  
Drive/Root is the drive resource is the top level object representing a user's OneDrive or a document library in SharePoint.  
Reference: <https://docs.microsoft.com/en-us/graph/api/resources/drive>

NEW QUESTION 12

- (Exam Topic 2)

You have an application that uses the Microsoft graph API.  
When users open the application during peak hours, they occasionally receive an HTTP 429 Too Many requests response status code.  
What should you to mitigate the errors?

- A. Adjust the request rate based on the Rate-Limit-Reset Header.
- B. Wait 100 milliseconds between requests.
- C. Adjust the request rate based on the Retry-After header.

**Answer:** C

#### NEW QUESTION 17

- (Exam Topic 2)

You have a starter SharePoint Framework (SPFx) web part.

You need to test the web part from the local workbench by connecting to a URL of `https://localhost:4321/temp/workbench.html`.

Which tool should you use make the web part available locally for debugging?

- A. Yeoman
- B. Microsoft Visual Studio Code
- C. npm install
- D. gulp serve

**Answer:** B

#### Explanation:

By setting up debugging of your SharePoint Framework solution in Visual Studio Code, you can more efficiently step through your code and fix errors.

When building SharePoint Framework solutions, you can use the local workbench to verify that your web part is working correctly. Using the local workbench is convenient for testing all scenarios that do not require communicating with SharePoint as well as for offline development.

Reference: <https://docs.microsoft.com/en-us/sharepoint/dev/spfx/debug-in-vscode>

#### NEW QUESTION 19

- (Exam Topic 2)

You are developing a front end web app.

You want to display the current username as part of the user interface.

You need to retrieve the current username from Microsoft Graph by using a REST request. The solution must minimize the amount of information returned.

To which URI should you send the request?

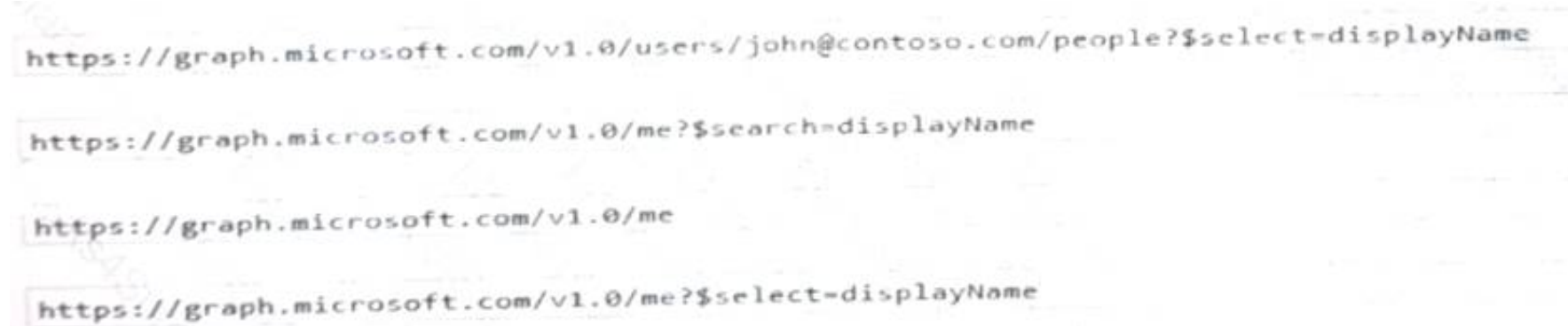

- A. Option A
- B. Option B
- C. Option C
- D. Option D

**Answer:** A

#### NEW QUESTION 22

- (Exam Topic 2)

Your company has a third-party invoicing web app.

You need to display the app within Microsoft Teams for one user only. The app will not require conversational interactions.

How should you display the app by using the minimum amount of effort?

- A. Instruct the user to add a website tab
- B. Instruct the user to add an App Studio app
- C. Create a SharePoint Framework (SPFx) web part
- D. Create a search-based messaging extension

**Answer:** A

#### Explanation:

There are currently three methods of app integration in Teams: Connectors, Bots, and Tabs. Tabs offer more extensive integration by allowing you to view entire third-party services within Microsoft Teams. Reference: <https://www.sherweb.com/blog/office-365/o365-microsoft-teams-apps/>

#### NEW QUESTION 25

- (Exam Topic 2)

You plan to develop a Microsoft Teams bot that will return product information to users by using an adaptive card.

You need to card to contain a button that will invoke a web search for the product. What should you use?

- A. An action-based messaging extension
- B. A task module
- C. A search-based messaging extension
- D. An outgoing webhook

**Answer:** B



### NEW QUESTION 30

- (Exam Topic 2)

You have an application that uses the Microsoft Graph API.

You need to configure the application to retrieve the groups to which the current signed-in user belongs. The results must contain the extended priorities of the groups.

Which URI should you use?

- A. <https://graph.microsoft.com/v1.0/me/getMemberObjects>
- B. <https://graph.microsoft.com/v1.0/me/getMemberGroups>
- C. <https://graph.microsoft.com/v1.0/me/memberOf>
- D. <https://graph.microsoft.com/v1.0/me/checkMemberGroups>

**Answer: B**

#### Explanation:

Get member groups returns all the groups that the specified user, group, or directory object is a member of. This function is transitive.

Reference: <https://docs.microsoft.com/en-us/graph/api/directoryobject-getmembergroups>

### NEW QUESTION 33

- (Exam Topic 2)

This question requires that you evaluate the underlined BOLD text to determine if it is correct.

You can use App Studio for Microsoft Teams to develop all the components of a bot application.

Instructions: Review the underlined text. If it makes the statement correct, select "No change is needed". If the statement is incorrect, select the answer choice that makes the statement correct.

- A. No change is needed
- B. configure a Teams tab in an application
- C. develop a SharePoint Framework (SPFx) web part
- D. provision a bot by using the Bot Framework

**Answer: B**

#### Explanation:

Tabs provide a place for you to display for rich interactive web content. You can define both personal and team tabs.

There can be only 1 team tab per app, but up to 16 personal tabs per app.

Reference: <https://blog.thoughtstuff.co.uk/2019/04/what-is-app-studio-in-microsoft-teams-and-why-do-i-care/>

### NEW QUESTION 37

- (Exam Topic 2)

You have an application that has the code shown in the exhibits. (Click the JavaScript Version tab or the C# Version tab.)

For each of the following statements, select Yes if the statement is true. Otherwise, select No. NOTE: Each correct selection is worth one point.

JavaScript Version

```
module.exports = function(context, myTrigger) {  
    //...  
    var group =  
    {  
        DisplayName: groupTitle,  
        GroupTypes: ["Unified"],  
        MailEnabled: true,  
        SecurityEnabled: false,  
        Visibility: "Private"  
    };  
    client.api('/groups').post(group).then((groupResult) => {  
        client.api('/users/${userName}').get().then((userResult) => {  
            var user = {  
                "@odata.id": 'https://graph.microsoft.com/v1.0/directoryObjects/${UserResult.Id}'  
            };  
            client.api('/groups/${groupResult.Id}/members/${ref}').post(user).then(() => {  
                context.done();  
            });  
        });  
    });  
};
```

C# Version



```
namespace MyProject
{
    public static class MainActivity
    {
        [FunctionName(nameof(MainActivity))]
        public static async Task Run([ActivityTrigger] string accessToken, string userEmail, string groupTitle)
        {
            var client = new GraphServiceClient(new GraphAuthProvider(accessToken));
            var group = new Group
            {
                DisplayName = groupTitle,
                GroupTypes = new string[] { "Unified" },
                MailEnabled = true,
                SecurityEnabled = false,
                Visibility = "Private"
            };
            var createdGroup = await client.Groups.Request().AddAsync(group);
            var user = await client.Users[userEmail].Request().GetAsync();
            await client.Groups[createdGroup.Id].Members.References.Request().AddAsync(user);
        }
    }
}
```

Statements	Yes	No
The code creates a unified group in Microsoft Office 365.	<input type="radio"/>	<input type="radio"/>
The code adds a member to a group.	<input type="radio"/>	<input type="radio"/>
The code adds an owner to a group.	<input type="radio"/>	<input type="radio"/>
The code creates a team in Microsoft Teams.	<input type="radio"/>	<input type="radio"/>

- A. Mastered
- B. Not Mastered

**Answer:** A

**Explanation:**

Box 1: Yes  
 Unified is specified in the code.  
 Note: You can create the following types of groups: Office 365 group (unified group)  
 Security group Box 2: Yes  
 A member is added to the group. Box 3: No  
 Box 4: No  
 Reference: <https://docs.microsoft.com/en-us/graph/api/group-post-groups>

**NEW QUESTION 39**

- (Exam Topic 2)  
 You are developing an Azure function to provision a team in Microsoft Teams.  
 You need to create a group named Project A, add a classification of Private to the group, and then convert Project A to a team group.  
 How should you complete the REST requests? To answer, select the appropriate options in the answer area. NOTE: Each correct selection is worth one point.

Request 1:

▼

https://graph.microsoft.com/v1.0/groups

GET

PATCH

POST

PUT

```
{
  "description": "",
  "displayName": "Project A",
  "groupTypes": ["Unified"],
  "mailEnabled": true,
  "mailNickname": "projecta",
  "securityEnabled": "projecta",
  "securityEnabled": false
}
```

Request 2:

▼

https://graph.microsoft.com/v1.0/groups/{GroupID}

GET

PATCH

POST

PUT

```
{
  "classification": "Private"
}
```

Request 3:

▼

https://graph.microsoft.com/v1.0/groups/{GroupID}/team

GET

PATCH

POST

PUT

```
{
  "memberSettings": {
    "allowCreateUpdateChannels": true
  }
}
```

- A. Mastered
- B. Not Mastered

Answer: A

Explanation:

Box 1: post

You need to create a group named Project A.

The following example creates an Office 365 group. POST https://graph.microsoft.com/v1.0/groups Content-type: application/json

Content-length: 244

```
{
  "description": "Self help community for library", "displayName": "Library Assist",
  "groupTypes": [ "Unified"
],
  "mailEnabled": true, "mailNickname": "library", "securityEnabled": false
}
```

Box 2: PATCH

Add a classification of Private to the group.

You can set the classification property in a PATCH request for the group, if do not set it in the initial POST request that creates the group.

Box 3: put

Then convert Project A to a team group. Syntax: PUT /groups/{id}/team

References: <https://docs.microsoft.com/en-us/graph/api/group-post-groups> <https://docs.microsoft.com/en-us/graph/api/resources/group>

<https://docs.microsoft.com/en-us/graph/api/team-put-teams>

NEW QUESTION 40

- (Exam Topic 2)

You are developing an application that will upload files that are larger than 50 MB to Microsoft OneDrive.

You need to recommend an upload solution to ensure that the file upload process can resume if a network error occurs during the upload.

Which four actions should you perform in sequence? To answer, move the actions from the list of actions to the answer area and arrange them in the correct order.

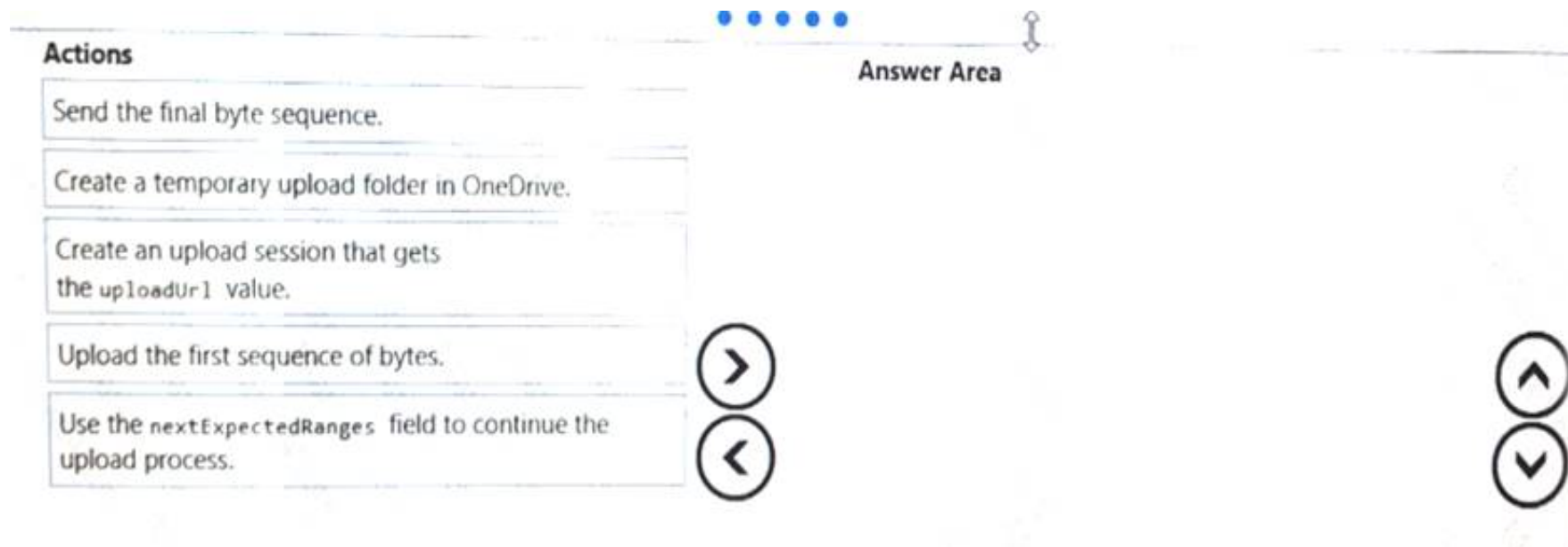

- A. Mastered  
 B. Not Mastered

**Answer: A**

**Explanation:**

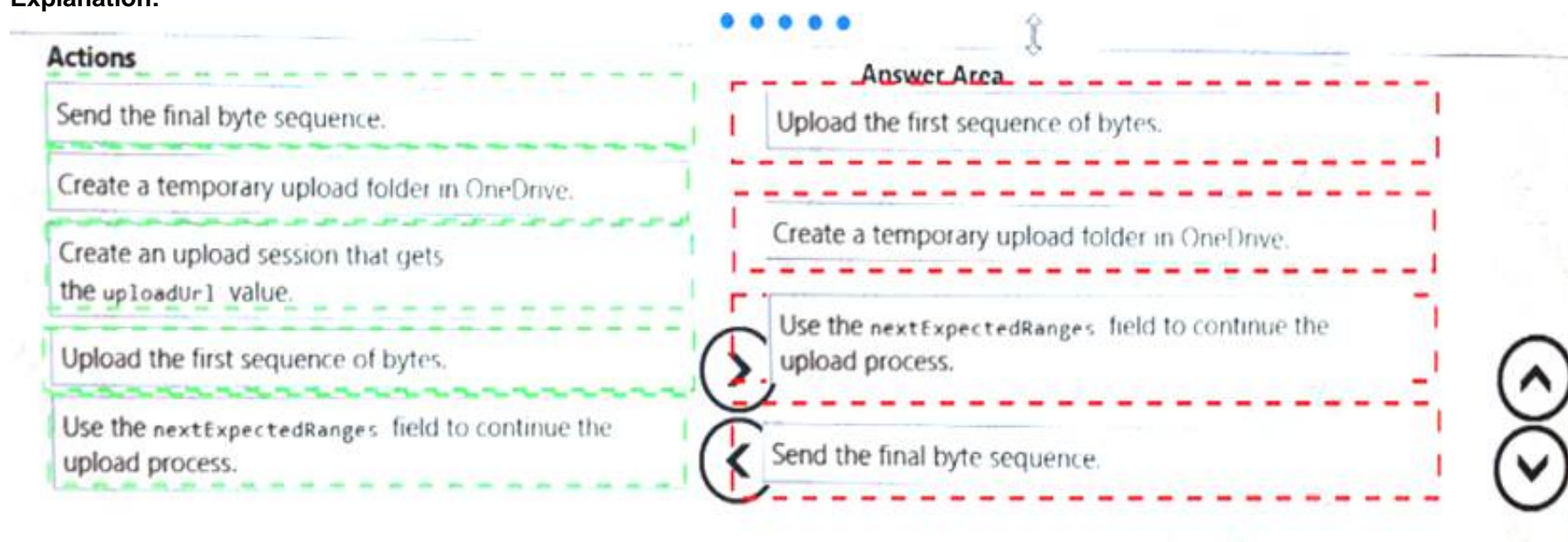

#### NEW QUESTION 43

- (Exam Topic 2)

You are building email notifications for an expensing system.

When a user receives an email notification, the email will contain a comment field. When the user submits a comment, the data will be returned to the expensing system for processing.

What should you do to implement the notification by using the minimum amount of development effort?

- A. Create a Microsoft Office Add-in that has an action pane to display the notifications  
 B. Leverage Microsoft Graph notifications  
 C. Leverage the Azure SignalR Service and implement web notifications  
 D. Configure the expensing system to send actionable messages

**Answer: D**

**Explanation:**

Whether you are filling out a survey, approving an expense report, or updating a CRM sales opportunity, Actionable Messages enable you to take quick actions right from within Outlook. Developers can now embed actions in their emails or notifications, elevating user engagement with their services and increasing organizational productivity.

Office 365 provides two solutions to enhance productivity with Outlook Actionable Messages: actionable messages via email, and actionable messages via Office 365 Connectors.

Reference: <https://docs.microsoft.com/en-us/outlook/actionable-messages/>

#### NEW QUESTION 46

- (Exam Topic 2)

You are designing a custom SharePoint Framework (SPFx) web part that will be deployed to modern Microsoft SharePoint sites.

You need to ensure that all the web part fields and controls adopt the theme of the site when you deploy the web part.

What should you use to develop the web part?

- A. Material-UI  
 B. Office UI Fabric React  
 C. HTML 5.0 and CSS  
 D. Fluid Framework

**Answer: B**

**Explanation:**



Office UI Fabric is Microsoft's official front end framework for building User Interface experiences for Office and Office 365. In simple terms it gives you the look and feel for your component. Moreover, they are open source, mobile responsive and reusable, no need to create from scratch just refer them in your code and start utilizing them.

Microsoft modern SharePoint out of the box webparts are made up these Office UI Fabric framework, so to maintain consistency look and feel as like Office it's better to use these components in our custom SPFx webparts.

Reference:

<http://www.sharepointsamples.com/sharepoint-framework-webpart-with-office-ui-fabric-react-component/>

#### NEW QUESTION 49

- (Exam Topic 2)

For each of the following statements, select Yes if the statement is true. Otherwise, select No.

NOTE: Each correct selection is worth one point.

Statements	Yes	No
You can use the Adaptive Cards Designer to create Microsoft Outlook actionable messages.	<input type="radio"/>	<input type="radio"/>
Microsoft Outlook actionable messages are written in JSON.	<input type="radio"/>	<input type="radio"/>
You need Azure Active Directory (Azure AD) tenant admin privileges to enable Microsoft Outlook actionable messages.	<input type="radio"/>	<input type="radio"/>

- A. Mastered
- B. Not Mastered

Answer: A

#### Explanation:

Box 1: Yes

The Adaptive Cards Designer provides a drag-and-drop experience to quickly build and tweak adaptive cards. Outlook Actionable Messages cards are designed using the Adaptive Card format.

The Adaptive Card format is a simple yet powerful declarative layout format that provides a lot of flexibility, allowing for visually rich cards. In this topic we'll cover the Outlook-specific features of the Adaptive Card format.

Box 2: Yes

The actionable message card is in JSON format. Box 3: No

By default, the Tenant Administrator can create, edit, clone, and delete tenants, and manage user accounts. Note:

To enable Actionable Messages the recipient of the task must be an Office 365 customer with permissions for the SharePoint online site.

No: Office 365 administrators can disable actionable messages via the Set-OrganizationConfig cmdlet. If actionable messages do not render, check with your administrator to make sure the feature is enabled in your organization.

Adaptive Cards Designer Microsoft outlook actionable messages

References: <https://docs.microsoft.com/en-us/outlook/actionable-messages/adaptive-card> <https://gingkoapp.com/create-tenant-administrator.html>

#### NEW QUESTION 53

- (Exam Topic 2)

This question requires that you evaluate the underlined text to determine if it is correct.

Microsoft Visual Studio Code contains samples that you can use to quickly prototype a Microsoft Office Web Add-in for Microsoft Word.

Instructions: Review the underlined text. If it makes the statement correct, select "No change is needed." If the statement is incorrect, select the answer choice that makes the statement correct.

- A. No change is needed.
- B. Microsoft AppSource
- C. The Office UI Fabric
- D. The Script Lab add-in

Answer: D

#### NEW QUESTION 55

- (Exam Topic 2)

You are developing an application that will track changes to the UserPrincipalName attribute of Microsoft 365 accounts.

You need to use a REST request to retrieve the information by using Microsoft Graph. The solution must minimize the amount of data retrieved.

What should you do?

- A. Use GET <https://graph.microsoft.com/v1.0/users/delta> for the first call
- B. Use the state token in subsequent calls.
- C. Use GET [https://graph.microsoft.com/v1.0/users/delta?\\$select=UserPrincipalName](https://graph.microsoft.com/v1.0/users/delta?$select=UserPrincipalName) for the first call
- D. Use the state token in subsequent calls.
- E. Use GET [https://graph.microsoft.com/v1.0/users?\\$select=UserPrincipalName](https://graph.microsoft.com/v1.0/users?$select=UserPrincipalName) for the calls and track the changes.
- F. Use GET <https://graph.microsoft.com/v1.0/users> for the calls and track the changes.

Answer: B

#### Explanation:

Use delta query to track changes in a resource collection

The typical call pattern is as follows: application begins by calling a GET request with the delta function on the desired resource.



- Microsoft
- The Graph sends a response containing the requested resource and a state token.

Example: Selecting three properties

The next example shows the initial request selecting three properties for change tracking, with default response behavior.

Note: Delta query enables applications to discover newly created, updated, or deleted entities without performing a full read of the target resource with every request.

Reference: <https://docs.microsoft.com/en-us/graph/api/user-delta>

#### NEW QUESTION 57

- (Exam Topic 2)

When developing a tab in Microsoft teams, personal, group, and shared tabs can all be implemented as configurable tabs.

Instructions: Review the underlined BOLD text, if it makes the statement correct, select " No change is needed if the statement is incorrect select the answer choice that makes the statement correct.

- A. No change is needed.
- B. Share the same code
- C. Be used in a conversation
- D. Have a configuration panel

**Answer:** A

#### NEW QUESTION 62

- (Exam Topic 2)

You are creating an application named App1 that will use the Microsoft identity platform. App1 will be accessed only by users from several different Microsoft 365 subscriptions.

Which Supported account types setting should you configure for App1?

- A. Accounts in this organizational directory only
- B. Accounts in any organizational directory and personal Microsoft a accounts
- C. Accounts in any organizational directory

**Answer:** B

#### NEW QUESTION 67

- (Exam Topic 2)

You plan to deploy a SharePoint Framework (SPFx) solution to the tenant app catalog.

Which attribute should you configure in the package-solution.json file to ensure that the solution is available immediately to all site collections?

- A. skipFeatureDeployment
- B. zippedPackage
- C. ClientSideComponentId
- D. isDomainIsolated

**Answer:** A

#### Explanation:

You can configure your SharePoint Framework components to be immediately available across the tenant when the solution package is installed to the tenant app catalog. This can be configured by using the skipFeatureDeployment attribute in the package-solution.json file.

Reference: <https://docs.microsoft.com/en-us/sharepoint/dev/spfx/tenant-scoped-deployment>

#### NEW QUESTION 69

- (Exam Topic 2)

You are developing in application named App1.

App1 needs to use the Microsoft Graph API to retrieve emails from Microsoft 365 for the current signed-in user. The solution must meet the following requirements:

- Emails that have attachments and are from bill@contoso.com must be retrieved.
- The results must show the subject of the email, the sender address, and the count of emails retrieved.

How should you complete the URI to retrieve the results? To answer, drag the appropriate values to the correct targets. Each value may be used once, more than once, or not at all. You may need to drag the split bar between panes or scroll to view content.

NOTE: Each correct selection is worth one point.

**Actions**

\$count

\$expand

\$filter

\$format

\$orderby

\$select

**Answer Area**

https://graph.microsoft.com/v1.0/me/messages?

Value

=true&

Value

=subject, from&

Value

hasAttachments

eq true and from/emailAddress/address eq 'bill@contoso.com'

- A. Mastered  
 B. Not Mastered

**Answer:** A

**Explanation:**

Box 1: \$count

Use \$count as a query parameter to include a count of the total number of items in a collection alongside the page of data values returned from the Graph, as in the following example:

GET https://graph.microsoft.com/v1.0/me/contacts?\$count=true Box 2: \$select

To specify a different set of properties to return than the default set provided by the Graph, use the \$select query option. The \$select option allows for choosing a subset or superset of the default set returned.

Box 3: \$filter

To filter the response data based on a set of criteria, use the \$filter query option.

The following example returns messages that have the address field of the from property equal to "jon@contoso.com".

The from property is of the complex type emailAddress.

GET https://graph.microsoft.com/v1.0/me/messages?\$filter=from/emailAddress/address eq 'jon@contoso.com' Reference: [https://developer.microsoft.com/en-us/graph/docs/overview/query\\_parameters](https://developer.microsoft.com/en-us/graph/docs/overview/query_parameters)

**NEW QUESTION 70**

- (Exam Topic 2)

This question requires that you evaluate the underlined text to determine if it is correct.

In Microsoft Word on Windows, before you can sideload a Microsoft Office Add-in. you must first upload the manifest to Microsoft\_pnePrivc.

Instructions: Review the underlined text. If it makes the statement correct, select "No change is needed." If the statement is incorrect, select the answer choice that makes the statement correct.

- A. No change is needed.  
 B. deploy the manifest to an Azure website  
 C. publish the manifest to a trusted network location  
 D. set Microsoft Edge to Developer Mode

**Answer:** A

**NEW QUESTION 74**

- (Exam Topic 2)

You are developing an application that will use Microsoft Graph.

You attempt to retrieve a list of the groups in your organization by using a URI of https://graph.microsoft.eom/vi.0/groups on behalf of the user.

The application fails. The diagnostic logs show the following information:

- \* An HTTP 403 Forbidden status code
- \* An Authorization\_RequestDenied error code
- \* The following error message: "Insufficient privileges to complete the operation."

You need to ensure that the application can retrieve the list of groups. The solution must use the principle of least privilege. Which two actions should you perform?

Each correct answer presents part of the solution.

NOTE; Each correct selection is worth one point.

- A. In the permission request for the application, request the Grou  
 B. Rea  
 C. All permission.  
 D. Grant tenant admin consent for the Group.Rea  
 E. All permission.  
 F. Configure the application to use application permissions.  
 G. In the permission request for the application, request the Grou  
 H. Readwrit  
 I. All permission

**Answer:** AD

**NEW QUESTION 78**

- (Exam Topic 2)

You have an application that employees use to schedule vacations. The application sets an automatic reply and an out-of-office event in the employees' Microsoft 365 calendar.

Employees who access the application from a mobile device report that the application is slow to make changes.

You need to replace the application calls to use batched request. Automatic reply must be set only if an out-of-office event is set successfully.

How should you complete the batch request? To answer, select the appropriate options in the answer area.

**Answer Area**

DELETE  
GET  
HEAD  
PATCH  
POST  
PUT

https://graph.microsoft.com/v1.0/\$batch

These are the selections for the first missing value:  
application/json

```

"requests": [
  {
    "id": "1",
    "method": "DELETE",
    "url": "/me/event",
    "body": {
      "subject": "on vacation",
      "showAs": "oof",
      "start": {
        "dateTime": "2019-08-27T14:49:06.595Z",
        "timeZone": "UTC"
      },
      "headers": {
        "Content-Type": "application/json"
      }
    },
    "dependsOn": [
      {
        "id": "2",
        "url": "/me/mail",
        "method": "POST",
        "body": {
          "automaticRepliesSetting": {
            "status": "Scheduled",
            "scheduledStartTime": {
              "dateTime": "2020-03-20T18:00:00.0000000",
              "timeZone": "UTC"
            },
            "scheduledEndTime": {
              "dateTime": "2020-03-26T18:00:00.0000000",
              "timeZone": "UTC"
            }
          }
        },
        "headers": {
          "Content-Type": "application/json"
        }
      }
    ]
  }
]
  
```

- A. Mastered  
 B. Not Mastered

**Answer: A**

**Explanation:**

## Answer Area



### NEW QUESTION 82

- (Exam Topic 2)

You are developing a SharePoint Framework (SPFx) web part. The web part will call a backed API that is secured by using Azure Active Directory (Azure AD). The web part will be on a page that has many other web parts.

Which type of web part should you use ensure that access to the exclusive to the web part?

- A. Provider-hosted
- B. SharePoint-hosted
- C. Domain isolated
- D. Connected

**Answer: A**

### NEW QUESTION 84

- (Exam Topic 2)

You are developing a Microsoft Teams solution to host an existing webpage as a Teams tab. Which requirement must the page meet?

- A. The page must adhere to HTML 5.0 standards
- B. The page must adhere to WCAG 2.0 accessibility guidelines
- C. The page must be hosted on a domain that is on the validDomains list of the manifest
- D. The page must use CSS3 stylesheets

**Answer: C**

#### Explanation:

Make sure that all domains used in your tab pages are listed in the manifest.json validDomains array. Reference: <https://docs.microsoft.com/en-us/microsoftteams/platform/tabs/how-to/create-tab-pages/configuration-page>

### NEW QUESTION 88

- (Exam Topic 2)

You are developing a Microsoft Team application. To host a webpage in a Teams tab, the manifest file must include the contentUrl property within the staticTabs property.

Instructions: Review the underline text. If the makes the statement correct, select " No change is needed. " If the statement is incorrect, select the answer choice that makes the statement correct.



- A. No change is needed.
- B. websiteUrl property within the configuragbleTabs property
- C. ValidDomain property within the configuragbleTabs property
- D. ValidDomain property within the statictabs property

Answer: B

NEW QUESTION 91

- (Exam Topic 2)

For each of the following statements, select Yes if the statement is true. Otherwise, select No. NOTE: Each correct select is worth one point.

Answer Area

Statements	Yes	No
A Microsoft Office Web Add-in can be scaffolded by using a Yeoman generator.	<input type="radio"/>	<input type="radio"/>
Microsoft Office Web Add-ins can be developed by using C#.	<input type="radio"/>	<input type="radio"/>
The code for a Microsoft Office Web Add-in has access to the local file system of a device.	<input type="radio"/>	<input type="radio"/>

- A. Mastered
- B. Not Mastered

Answer: A

Explanation:

Answer Area

Statements	Yes	No
A Microsoft Office Web Add-in can be scaffolded by using a Yeoman generator.	<input checked="" type="radio"/>	<input type="radio"/>
Microsoft Office Web Add-ins can be developed by using C#.	<input checked="" type="radio"/>	<input type="radio"/>
The code for a Microsoft Office Web Add-in has access to the local file system of a device.	<input checked="" type="radio"/>	<input type="radio"/>

NEW QUESTION 96

- (Exam Topic 2)

You are building a Microsoft Outlook add-in.

Which object should you use to save additional information in an email?

- A. CustomProperties
- B. CustomXMLParts
- C. RoamingSettings
- D. localStorage

Answer: B

NEW QUESTION 99

- (Exam Topic 2)

You are developing a web app that will display emails from the Microsoft 365 mailbox of the current signed-in user.

For performance reasons, you do not want all the emails to be loaded simultaneously, rather page-by-page as the user navigates the app.

You plan to display 30 emails per page. The most recent emails must be displayed first.

How should you complete the query parameters for the REST request to display the third page of emails? To answer, drag the appropriate query parameters to the correct targets. Each query parameter may be used once, more than once, or not at all. You may need to drag the split bar between panes or scroll to view content.

NOTE: Each correct selection is worth one point.

Actions	Answer Area
filter	GET <a href="https://graph.microsoft.com/v1.0/me/messages?\$">https://graph.microsoft.com/v1.0/me/messages?\$</a> <div>Parameter</div> =60&\$ <div>Parameter</div> =30&\$orderby=sentDateTime desc
search	
select	
skip	
top	

- A. Mastered  
 B. Not Mastered

**Answer:** A

**Explanation:**

Box 1: top

Number of items to return in a result Box 2: skip

\$skip Indexes into a result set. Also used by some APIs to implement paging and can be used together with \$top to manually page results.

Reference: [https://developer.microsoft.com/en-us/graph/docs/overview/query\\_parameters](https://developer.microsoft.com/en-us/graph/docs/overview/query_parameters)

**NEW QUESTION 100**

- (Exam Topic 2)

You are evaluating the SharePoint Framework (SPFx) ListView Command Set extension. For each of the following statements, select Yes if the statement is true. Otherwise, select No. NOTE: Each correct selection is worth one point.

Statements	Yes	No
The ListView Command Set extension is a client-side component that runs inside the context of a Microsoft SharePoint page.	<input type="radio"/>	<input type="radio"/>
You can create custom toolbar buttons in lists and libraries by using the ListView Command Set extension.	<input type="radio"/>	<input type="radio"/>
You can create context menu items in lists and libraries by using the ListView Command Set extension.	<input type="radio"/>	<input type="radio"/>

- A. Mastered  
 B. Not Mastered

**Answer:** A

**Explanation:**

Box 1: Yes

Extensions are client-side components that run inside the context of a SharePoint page. Box 2: Yes

ClientSideExtension.ListViewCommandSet.CommandBar: The top command set menu in a list or library.

Box 3: Yes

ClientSideExtension.ListViewCommandSet.ContextMenu: The context menu of the item(s). Reference:

<https://docs.microsoft.com/en-us/sharepoint/dev/spfx/extensions/get-started/building-simple-cmdset-with-dialog>

**NEW QUESTION 105**

- (Exam Topic 2)

For each of the following statements, select Yes if the statement is true. Otherwise, select No.

NOTE: Each correct selection is worth one point.

Statements	Yes	No
A Microsoft Teams bot receives a notification when a user clicks a conversation to which the bot is deployed.	<input type="radio"/>	<input type="radio"/>
A Microsoft Teams bot receives a notification when the team membership changes for a team of which the bot is a member.	<input type="radio"/>	<input type="radio"/>
A Microsoft Teams bot receives a notification when a user likes a message of the boot.	<input type="radio"/>	<input type="radio"/>

- A. Mastered  
 B. Not Mastered

**Answer:** A

**Explanation:**

Box 1: No

Box 2: Yes

Partial table lists the events that your bot can receive and take action on.

Type	Payload object	Teams eventType	Description
conversationUpdate	membersAdded	teamMemberAdded	Member added to team
conversationUpdate	membersRemoved	teamMemberRemoved	Member was removed from team

Box 3: Yes

The messageReaction event is sent when a user adds or removes his or her reaction to a message which was originally sent by your bot.

Reference: <https://docs.microsoft.com/en-us/microsoftteams/platform/resources/bot-v3/bots-notifications>

**NEW QUESTION 107**

.....

## Thank You for Trying Our Product

### We offer two products:

1st - We have Practice Tests Software with Actual Exam Questions

2nd - Questions and Answers in PDF Format

### MS-600 Practice Exam Features:

- \* MS-600 Questions and Answers Updated Frequently
- \* MS-600 Practice Questions Verified by Expert Senior Certified Staff
- \* MS-600 Most Realistic Questions that Guarantee you a Pass on Your FirstTry
- \* MS-600 Practice Test Questions in Multiple Choice Formats and Updatesfor 1 Year

**100% Actual & Verified — Instant Download, Please Click**  
**[Order The MS-600 Practice Test Here](#)**